

Table Top Components

Including Mat Top Components

Dillin Automation
S Y S T E M S C O R P

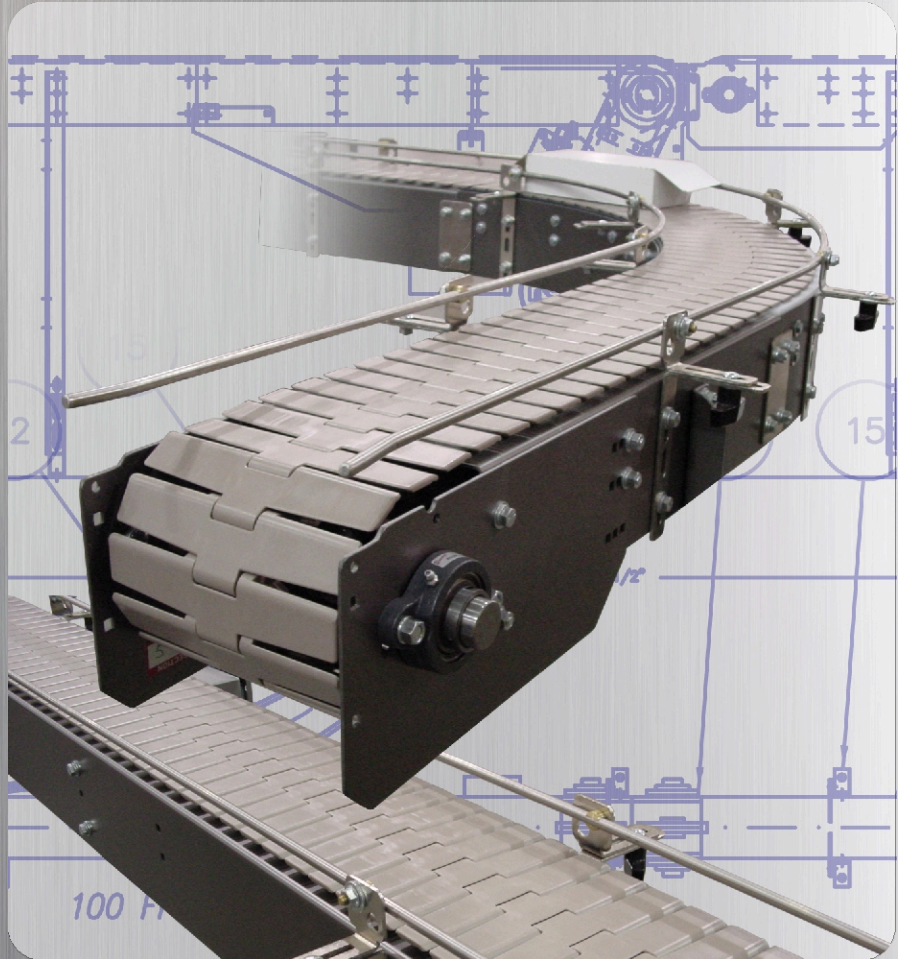

Table of Contents

Corporate Profile.....	2	M-1100 Series Mat Top Conveyor Component Section:	
T-Series Table Top Conveyor Component Section:		Intermediate Section Description.....	18
Intermediate Section Description.....	3	1'-0" to 10'-0" Intermediate Selection.....	19
1'-0" to 10'-0" Intermediate Selection.....	4	Drive Mounted High Section.....	20
Drive Section Description.....	5	Drive Mounted Low & Center Section.....	21
Drive Mounted High & Low Selection.....	6	Idler End Section	22
Idler End Section & Selection.....	7	M-2400 Series Mat Top Conveyor Component Section:	
15° Curve Section & Selection.....	8	Intermediate Section Description.....	23
30° Curve Section & Selection.....	9	1'-0" to 10'-0" Intermediate Selection.....	24
45° Curve Section & Selection.....	10	Drive Mounted High Section.....	25
60° Curve Section & Selection.....	11	Drive Mounted Low & Center Section.....	26
90° Curve Section & Selection.....	12	Idler End Section	27
M-900 Series Mat Top Conveyor Component Section:		Technical	
Intermediate Section Description.....	13	F.P.M. Section.....	28
1'-0" to 10'-0" Intermediate Selection.....	14		
Drive Mounted High Section.....	15		
Drive Mounted Low & Center Section.....	16		
Idler End Section	17		

Dillin Automation Systems

“We Solve your Productivity Puzzle”

With its subsidiaries: Dillin Engineered Systems, Dillin Control Systems and Dillin Capping Equipment, DAS offers a wide variety of products and capabilities which can be custom tailored to solve your specific packaging line productivity problems.

DILLIN AUTOMATION SYSTEMS specializes in Accumulation and Conveying Technology, System Integration, Controls and Panel Building and Capping and Closure Solutions.

With a combined 60 plus years of experience, our Solution Proving Team can assist you with the most basic of applications or the “Packaging Line of Your Future”. . . today.

DAS is a member of PMMI and specializes in package handling to include unwrapped food, cartons, cups, bag and pouches, caps, PET containers, trays, cases and pallets.

Our technology pedigree includes the following patents: ROE-LIFT[®] Over-The-Top[®] Vertical Accumulators, AIR DECK[®], QuickSet[®] Guides and Changeover System, Rwave[®] Transfer, and “Soft-Touch”[®] Low Line Pressure Accumulation.

Our knowledgeable sales persons, applications engineers, design engineers, project managers and highly qualified production technicians have a common goal . . . to help you, our valued client, take the puzzle out of your productivity challenges. We will do anything in our power to get you the solution you need and then stick with you in the years to come. . . because that’s how we both succeed!



TABLE TOP INTERMEDIATE SELECTION

"T"-SERIES

Description

The intermediate section transports product between the Drive and Idle / Tail Assemblies

Applications

- Accumulating light duty cartons, Pouches, bags, cans, bottles, etc.
- Minimum back pressure
- Economical

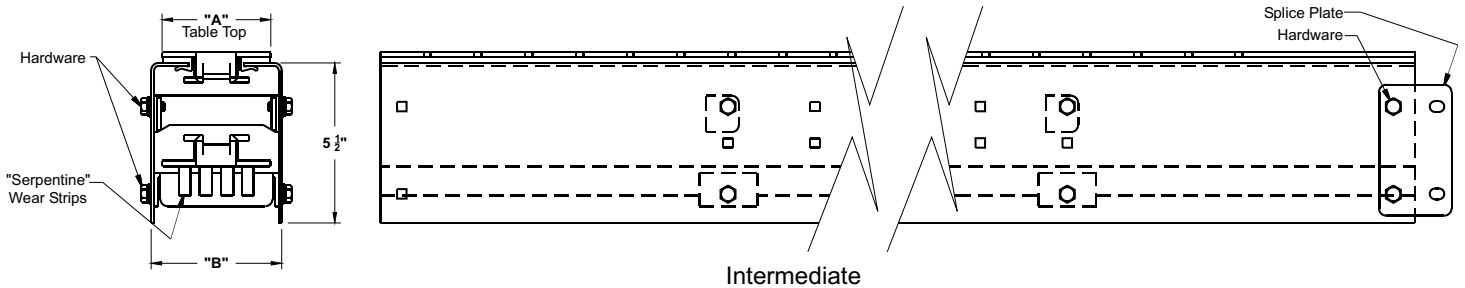
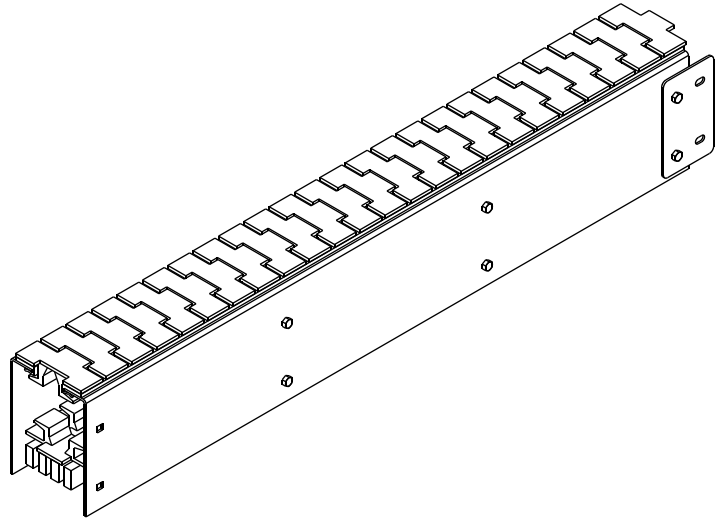

Standard Specifications:

Bed (Painted) - Standard Open design 11 ga. mild steel (Reference picture-this page)

Bed (Stainless Steel) - Standard Open design 12 ga. stainless steel (Reference picture-this page)

Side frame depth: 5 1/2 " Deep side frame

Table top chain: Tab style plastic low friction chain is included for the intermediate section only

Width: Overall width to be approximately size "B" (Reference picture-this page)

Supports: Floor supports are **not included** with the intermediate (Reference Conveyor Accessories Catalog)

Drive package: Standard drive package available (Reference to drive section)

Guiderails: Guiderails are **not included** (Reference Conveyor Accessories Catalog)

Wear strips: Returns and wear strips are included (Reference picture-this page)

Hardware: All connecting plates and fasteners are included for one end.

1'-0" Intermediate			
Part #	"A"	"B"	"C"
T-325-12	0'-3 1/4"	0'-4 1/2"	1'-0"
T-S325-12			
T-450-12	0'-4 1/2"	0'-5 1/4"	
T-S450-12			
T-750-12	0'-7 1/2"	0'-8 1/4"	
T-S750-12			
T-1000-12	0'-10"	0'-10 3/4"	
T-S1000-12			
T-1200-12	1'-0"	1'-0 3/4"	
T-S1200-12			

2'-0" Intermediate			
Part #	"A"	"B"	"C"
T-325-24	0'-3 1/4"	0'-4 1/2"	2'-0"
T-S325-24			
T-450-24	0'-4 1/2"	0'-5 1/4"	
T-S450-24			
T-750-24	0'-7 1/2"	0'-8 1/4"	
T-S750-24			
T-1000-24	0'-10"	0'-10 3/4"	
T-S1000-24			
T-1200-24	1'-0"	1'-0 3/4"	
T-S1200-24			

3'-0" Intermediate			
Part #	"A"	"B"	"C"
T-325-36	0'-3 1/4"	0'-4 1/2"	3'-0"
T-S325-36			
T-450-36	0'-4 1/2"	0'-5 1/4"	
T-S450-36			
T-750-36	0'-7 1/2"	0'-8 1/4"	
T-S750-36			
T-1000-36	0'-10"	0'-10 3/4"	
T-S1000-36			
T-1200-36	1'-0"	1'-0 3/4"	
T-S1200-36			

4'-0" Intermediate			
Part #	"A"	"B"	"C"
T-325-48	0'-3 1/4"	0'-4 1/2"	4'-0"
T-S325-48			
T-450-48	0'-4 1/2"	0'-5 1/4"	
T-S450-48			
T-750-48	0'-7 1/2"	0'-8 1/4"	
T-S750-48			
T-1000-48	0'-10"	0'-10 3/4"	
T-S1000-48			
T-1200-48	1'-0"	1'-0 3/4"	
T-S1200-48			

5'-0" Intermediate			
Part #	"A"	"B"	"C"
T-325-60	0'-3 1/4"	0'-4 1/2"	5'-0"
T-S325-60			
T-450-60	0'-4 1/2"	0'-5 1/4"	
T-S450-60			
T-750-60	0'-7 1/2"	0'-8 1/4"	
T-S750-60			
T-1000-60	0'-10"	0'-10 3/4"	
T-S1000-60			
T-1200-60	1'-0"	1'-0 3/4"	
T-S1200-60			

6'-0" Intermediate			
Part #	"A"	"B"	"C"
T-325-72	0'-3 1/4"	0'-4 1/2"	6'-0"
T-S325-72			
T-450-72	0'-4 1/2"	0'-5 1/4"	
T-S450-72			
T-750-72	0'-7 1/2"	0'-8 1/4"	
T-S750-72			
T-1000-72	0'-10"	0'-10 3/4"	
T-S1000-72			
T-1200-72	1'-0"	1'-0 3/4"	
T-S1200-72			

7'-0" Intermediate			
Part #	"A"	"B"	"C"
T-325-84	0'-3 1/4"	0'-4 1/2"	7'-0"
T-S325-84			
T-450-84	0'-4 1/2"	0'-5 1/4"	
T-S450-84			
T-750-84	0'-7 1/2"	0'-8 1/4"	
T-S750-84			
T-1000-84	0'-10"	0'-10 3/4"	
T-S1000-84			
T-1200-84	1'-0"	1'-0 3/4"	
T-S1200-84			

8'-0" Intermediate			
Part #	"A"	"B"	"C"
T-325-96	0'-3 1/4"	0'-4 1/2"	8'-0"
T-S325-96			
T-450-96	0'-4 1/2"	0'-5 1/4"	
T-S450-96			
T-750-96	0'-7 1/2"	0'-8 1/4"	
T-S750-96			
T-1000-96	0'-10"	0'-10 3/4"	
T-S1000-96			
T-1200-96	1'-0"	1'-0 3/4"	
T-S1200-96			

9'-0" Intermediate			
Part #	"A"	"B"	"C"
T-325-108	0'-3 1/4"	0'-4 1/2"	9'-0"
T-S325-108			
T-450-108	0'-4 1/2"	0'-5 1/4"	
T-S450-108			
T-750-108	0'-7 1/2"	0'-8 1/4"	
T-S750-108			
T-1000-108	0'-10"	0'-10 3/4"	
T-S1000-108			
T-1200-108	1'-0"	1'-0 3/4"	
T-S1200-108			

10'-0" Intermediate			
Part #	"A"	"B"	"C"
T-325-120	0'-3 1/4"	0'-4 1/2"	10'-0"
T-S325-120			
T-450-120	0'-4 1/2"	0'-5 1/4"	
T-S450-120			
T-750-120	0'-7 1/2"	0'-8 1/4"	
T-S750-120			
T-1000-120	0'-10"	0'-10 3/4"	
T-S1000-120			
T-1200-120	1'-0"	1'-0 3/4"	
T-S1200-120			

How To Order

Model: **X-X XXX-XX-XX**

Component series

- (T) Table Top
- (S) Is placed here for Stainless Steel construction

Table Top chain widths:

- (325) = 3 1/4" wide
- (450) = 4 1/2" wide
- (750) = 7 1/2" wide
- (1000) = 10" wide
- (1200) = 12" wide

Paint color (Leave blank if Stainless Steel)

- (01) Blue
- (02) Crème
- (03) Safety Yellow
- (04) Safety Orange
- (05) Medium Metallic Grey
- (06) White
- (07) Dark Blue

Actual length of intermediate (example: 12 = 1'-0") Refer to selection tables for correct lengths

How To Order

Individual Order Setup Charge:
Any Single intermediate order of 60" (5'-0") Long or Less is subject to a setup charge of \$200.00

TABLE TOP DRIVE SELECTION

"T"-SERIES

Description

The drive end is the portion of conveyor is where the motor is located. The product transport chain ends at this location and becomes the return chain.

Applications

- Accumulating light duty cartons, Pouches, bags, cans, bottles, etc.
- Minimum back pressure
- Economical

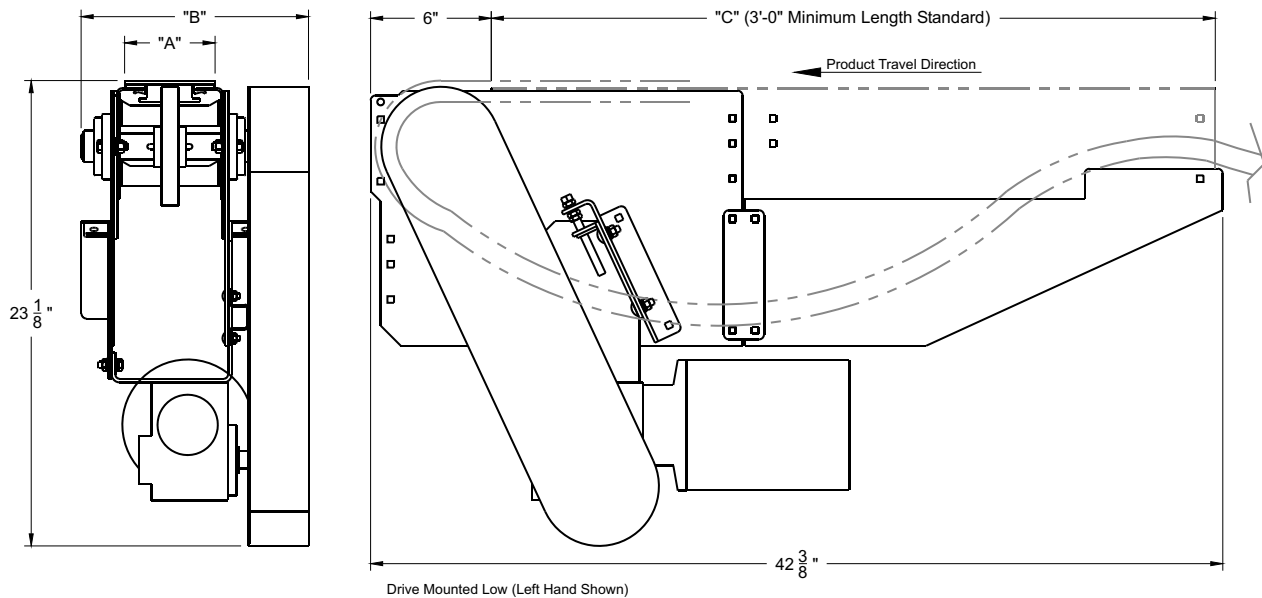

Drive Mounted Low (Left Hand Shown)

Standard Specifications:

Bed (Painted) - Standard Open design 11 ga. mild steel (Reference picture-this page)

Bed (Stainless Steel) - Standard Open design 12 ga. stainless steel (Reference picture-this page)

Side frame depth - 15" Deep side frame (drive end)

Table top chain - Tab style plastic low friction chain is included for the drive section only

Width - Overall width to be approximately size "B" (Reference picture-next page for drive mounted high & low)

Supports - Floor supports are **not included** with the intermediate (Reference Conveyor Accessories Catalog)

Transfers - End to end transfers are **not included** (Reference Conveyor Accessories Catalog)

Drive package - UP to 1 hp 208-230-4603/60 motor std. Larger horsepower motor are available. Fixed speed between 50 and 200 F.P.M. (Specify) (Reference F.P.M. selection section)

Guiderails - Guiderails are **not included** (Reference to Conveyor Accessories Catalog)

Wear strip - Returns and wear strips are included (Reference picture-this page)

Hardware - All connecting plates and fasteners are included for one. Additional mounting plates are available at an additional cost.

Electrical - Electrical connections are **not included** (Reference to Controls Accessories Catalog)

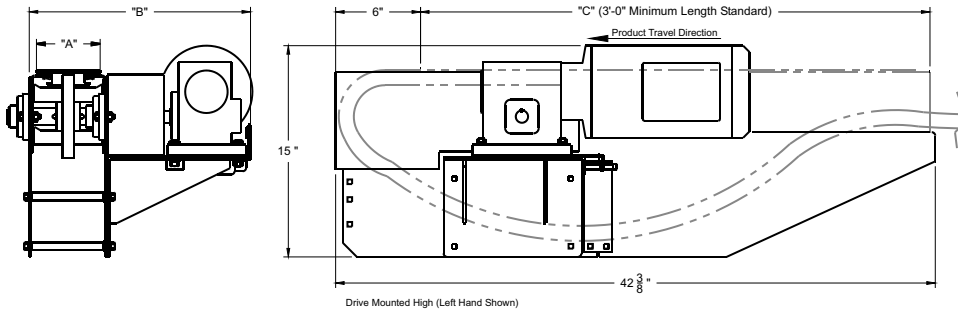

Drive Mounted High (left hand shown)

Part #	"A"	"B"	"C"
T-325-DLH	0'-3 1/4"	1'-4 7/8"	3'-0"
T-325-DRH			
T-S325-DLH			
T-S325-DRH	0'-4 1/2"	1'-3 5/8"	
T-450-DLH			
T-450-DRH			
T-S450-DLH	0'-7 1/2"	1'-6 5/8"	
T-S450-DRH			
T-750-DLH			
T-750-DRH	0'-10"	1'-9 1/8"	
T-S750-DLH			
T-S750-DRH			
T-1000-DLH	1' - 0"	1'-11 1/8"	
T-1000-DRH			
T-S1000-DLH			
T-S1000-DRH			
T-1200-DLH			
T-1200-DRH			
T-S1200-DLH			
T-S1200-DRH			

How To Order

Model: X-X XXX-XXX-XX-XX-XXX

Component series (T) Table Top

(S) Is placed here for Stainless Steel construction

Table Top chain widths:
 (325) = 3 1/4" wide
 (450) = 4 1/2" wide
 (750) = 7 1/2" wide
 (1000) = 10" wide
 (1200) = 12" wide

Table Top drive position:
 (DLH) Drive, Left Hand, Mounted High
 (DRH) Drive, Right Hand, Mounted High
 (DLU) Drive, Left Hand, Mounted Low
 (DRU) Drive, Right Hand, Mounted Low

Denotes F.P.M. (Feet Per Minute) requirements. Refer to selection tables for correct F.P.M. (example: 150 = 150 F.P.M.)

Denotes horse power requirements:
 (05) 1/2 HP (Included in Standard pricing)
 (75) 3/4 HP (Add to std. price)
 (10) 1 HP (Add to std. price)
 (15) 1 1/2 HP (Add to std. price)

Paint color (Leave blank if Stainless Steel)
 (01) Blue
 (02) Crème
 (03) Safety Yellow
 (04) Safety Orange
 (05) Medium Metallic Grey
 (06) White
 (07) Dark Blue

How To Order

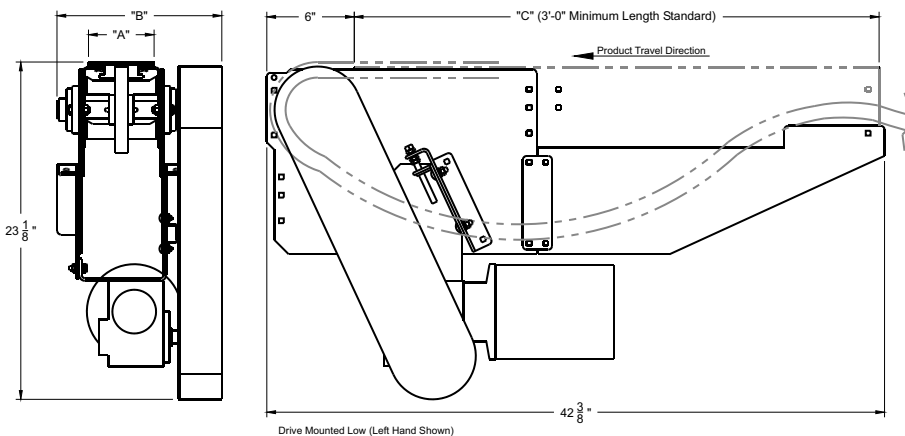

Drive Mounted Low (left hand shown)

Part #	"A"	"B"	"C"
T-325-DLU	0'-3 1/4"	0-10 1/2"	3'-0"
T-325-DRU			
T-S325-DLU			
T-S325-DRU	0'-4 1/2"	0'-11 1/4"	
T-450-DLU			
T-450-DRU			
T-S450-DLU	0'-7 1/2"	1'-2 1/4"	
T-S450-DRU			
T-750-DLU			
T-750-DRU	0'-10"	1'-4 3/4"	
T-S750-DLU			
T-S750-DRU			
T-1000-DLU	1'-0"	1'-6 3/4"	
T-1000-DRU			
T-S1000-DLU			
T-S1000-DRU			
T-1200-DLU			
T-1200-DRU			
T-S1200-DLU			
T-S1200-DRU			

TABLE TOP IDLER/TAIL SECTION "T"-SERIES

Description

The idler end is the portion of conveyor opposing the drive end. The returning chain as it returns becomes the product transport chain at this point.

Applications

- Accumulating light duty cartons, Pouches, bags, cans, bottles, etc.
- Minimum back pressure
- Economical

Idler / Tail			
Part #	"A"	"B"	"C"
T-325-T	0'-3 1/4"	1'-6"	3'-0"
T-S325-T			
T-450-T	0'-4 1/2"		
T-S450-T			
T-750-T	0'-7 1/2"		
T-S750-T			
T-1000-T	0'-10"		
T-S1000-T			
T-1200-T	1'-0"		
T-S1200-T			

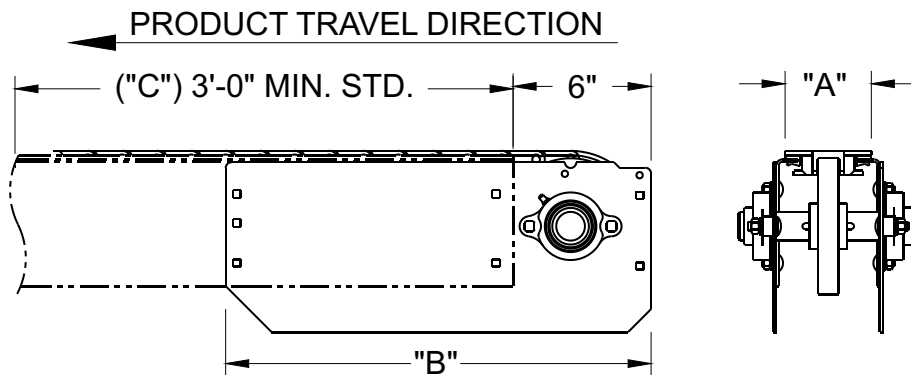

Standard Specifications:

Bed (Painted) - Standard Open design 11 ga. mild steel (Reference picture-this page)

Bed (Stainless Steel) - Standard Open design 12 ga. stainless steel (Reference picture-this page)

Side frame depth - 7 1/2 " Deep side frame

Table top chain - Tab style plastic low friction chain is included for the Idler / Tail section onlt

Width - Overall width to be approximately size "B" (Reference picture-this page)

Supports - Floor supports are **not included** with the Idler / Tail section (Reference Conveyor Accessories Catalog)

Transfers - End to end transfers are **not included** (Reference Conveyor Accessories Catalog)

Guiderails - Guiderails are **not included** (Reference Conveyor Accessories Catalog)

Wear strip - Returns and wear strips are included (Reference picture-this page)

Hardware - All connecting plates and fasteners are included for one end. Additional mounting plates are available at an additional cost.

How To Order

Model: X-X XXX-X-XX

<p>Component series (T) Table Top</p> <p>(S) Is placed here for Stainless Steel construction</p> <p>Table Top chain widths: (325) = 3 1/4" wide (450) = 4 1/2" wide (750) = 7 1/2" wide (1000) = 10" wide (1200) = 12" wide</p>	<p>Paint color (Leave blank if Stainless Steel)</p> <p>(01) Blue (02) Crème (03) Safety Yellow (04) Safety Orange (05) Medium Metallic Grey (06) White (07) Dark Blue</p> <p>(T) Is placed here for Tail Section (Idler End)</p>
--------------------------------------------------------------------------------------------------------------------------------------------------------------------------------------------------------------------------------------------------------------------------------------------------------------------------------------------------------------	----------------------------------------------------------------------------------------------------------------------------------------------------------------------------------------------------------------------------------------------------------------------------------------------------------------------------------------------------------------------------------------

How To Order

TABLE TOP 15° CURVE SELECTION

“T” SERIES

Description

Utilizing side-flexing chain these curve sections enable continuous direction changing motion without additional dead plates or drives.

Applications

- Accumulating light duty cartons, Pouches, bags, cans, bottles, etc.
- Minimum back pressure
- Economical

15° Curve			
Part #	“A”	“B”	“C”
T-325-15C	0'-3 1/4"	0'-4 1/2"	24" Rad.
T-S325-15C	0'-3 1/4"	0'-4 1/2"	
T-450-15C	0'-4 1/2"	0'-5 1/4"	
T-S450-15C	0'-4 1/2"	0'-5 1/4"	
T-750-15C	0'-7 1/2"	0'-8 1/4"	
T-S-750-15C	0'-7 1/2"	0'-8 1/4"	
T-1000-15C	0'-10"	0'-10 3/4"	
T-S1000-15C	0'-10"	0'-10 3/4"	
T-1200-15C	1'-0"	1'-0 3/4"	
T-S1200-15C	1'-0"	1'-0 3/4"	

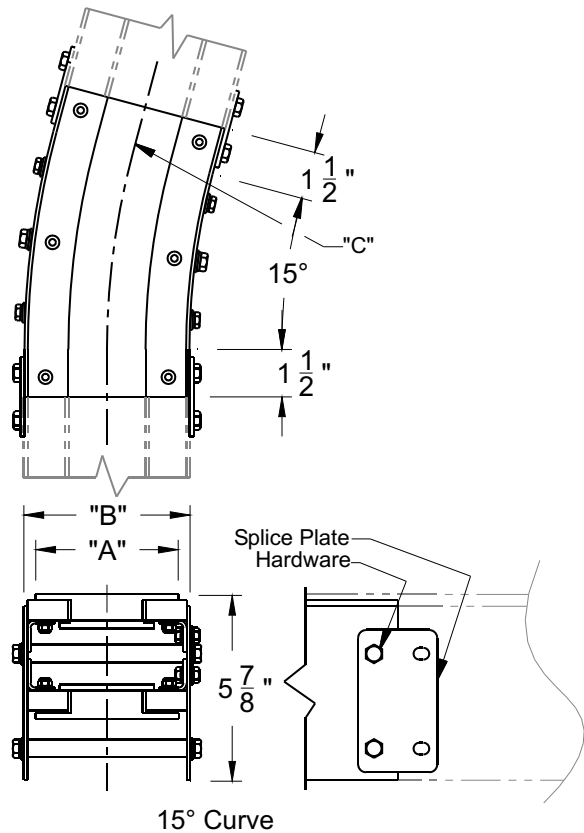

Standard Specifications:

Bed (Painted) - Standard Open design 11 ga. mild steel (Reference picture-this page)

Bed (Stainless Steel) - Standard Open design 12 ga. stainless steel (Reference picture-this page)

Side frame depth - 5-7/8" Deep side frame

Table top chain - Tab style plastic low friction chain is included for the curve section only

Width - Overall width to be approximately size “B” (Reference picture-this page)

Curve Wear Strips - Returns and wear strips are included (Reference picture - this page).

*Outer curve wear strip is UHMW.

*Inner curve wear strip is lubricated UHMW. For speeds up to 150 F.P.M.

*Inner curve wear strip is Nylatron. For speeds over 150 F.P.M.

*Returns and wear strips are included (Reference picture - this page).

Radius Dimension - Radius is measured to centerline of chain.

How To Order

Model: **X-X XXX-XXX-XX**

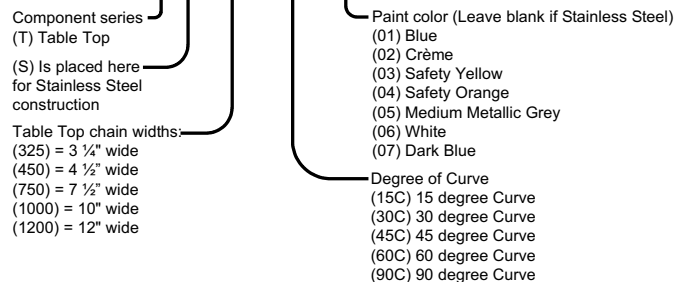

How To Order

Supports - Floor supports are **not included** with the curve section (Reference Conveyor Accessories catalog)

Guiderails - Guiderails are **not included** (Reference Conveyor Accessories catalog)

Hardware - All connecting plates and fasteners are included for one end. Additional mounting plates are available at an additional cost.

TABLE TOP 30° CURVE SELECTION

“T”-SERIES

Description

Utilizing side-flexing chain these curve sections enable continuous direction changing motion without additional dead plates or drives.

Applications

- Accumulating light duty cartons, Pouches, bags, cans, bottles, etc.
- Minimum back pressure
- Economical

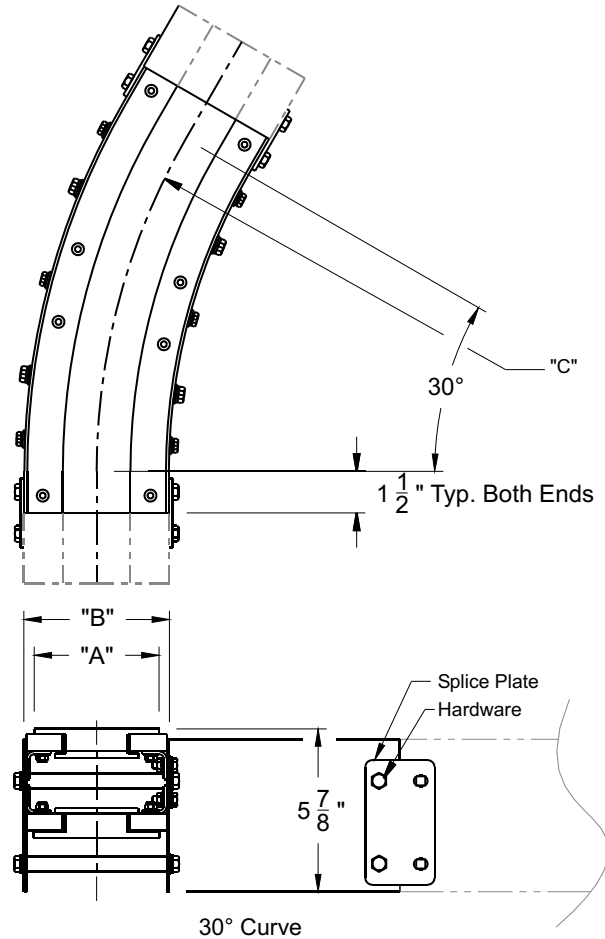

30° Curve			
Part #	"A"	"B"	"C"
T-325-30C	0'-3 1/4"	0'-4 1/2"	24" Rad.
T-S325-30C			
T-450-30C	0'-4 1/2"	0'-5 1/4"	
T-S450-30C			
T-750-30C	0'-7 1/2"	0'-8 1/4"	
T-S-750-30C			
T-1000-30C	0'-10"	0'-10 3/4"	
T-S1000-30C			
T-1200-30C	1'-0"	1'-0 3/4"	
T-S1200-30C			

Standard Specifications:

Bed (Painted) - Standard Open design 11 ga. mild steel (Reference picture-this page)

Bed (Stainless Steel) - Standard Open design 12 ga. stainless steel (Reference picture-this page)

Side frame depth - 5-7/8" Deep side frame

Table top chain - Tab style plastic low friction chain is included for the curve section only

Width - Overall width to be approximately size "B" (Reference picture-this page)

Curve Wear Strips - Returns and wear strips are included (Reference picture - this page).

*Outer curve wear strip is UHMW.

*Inner curve wear strip is lubricated UHMW. For speeds up to 150 F.P.M.

*Inner curve wear strip is Nylatron. For speeds over 150 F.P.M.

*Returns and wear strips are included (Reference picture - this page).

Radius Dimension - Radius is measured to centerline of chain.

How To Order

Model: **X-X XXX-XXX-XX**

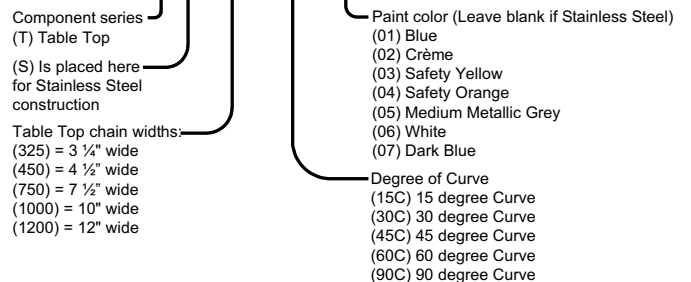

How To Order

Supports - Floor supports are **not included** with the curve section (Reference Conveyor Accessories catalog)

Guiderails - Guiderails are **not included** (Reference Conveyor Accessories catalog)

Hardware - All connecting plates and fasteners are included for one end. Additional mounting plates are available at an additional cost.

TABLE TOP 45° CURVE SELECTION

“T”-SERIES

Description

Utilizing side-flexing chain these curve sections enable continuous direction changing motion without additional dead plates or drives.

Applications

- Accumulating light duty cartons, Pouches, bags, cans, bottles, etc.
- Minimum back pressure
- Economical

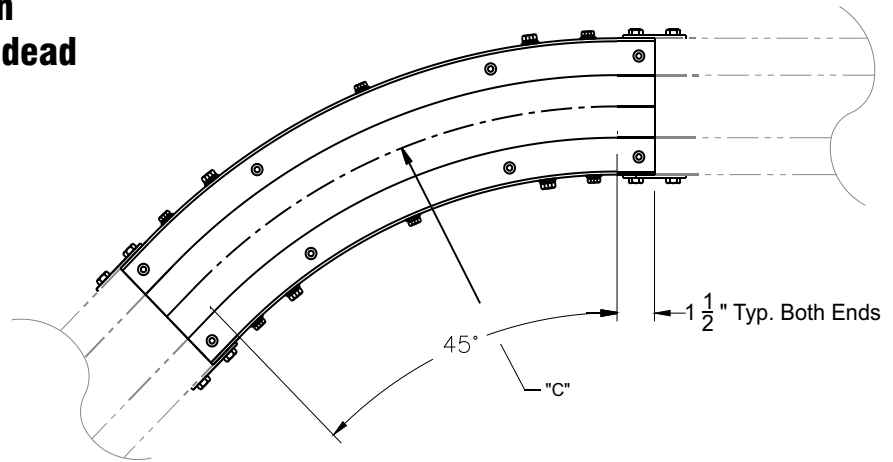

45° Curve			
Part #	"A"	"B"	"C"
T-325-45C	0'-3 1/4"	0'-4 1/2"	24" Rad.
T-S325-45C			
T-450-45C	0'-4 1/2"	0'-5 1/4"	
T-S450-45C			
T-750-45C	0'-7 1/2"	0'-8 1/4"	
T-S-750-45C			
T-1000-45C	0'-10"	0'-10 3/4"	
T-S1000-45C			
T-1200-45C	1'-0"	1'-0 3/4"	
T-S1200-45C			

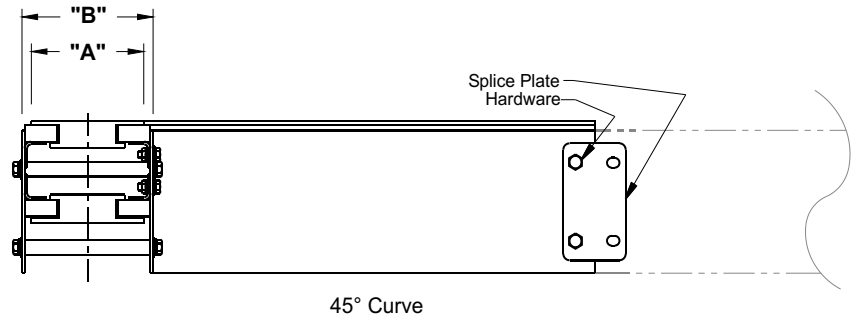

Standard Specifications:

Bed (Painted) - Standard Open design 11 ga. mild steel (Reference picture-this page)

Bed (Stainless Steel) - Standard Open design 12 ga. stainless steel (Reference picture-this page)

Side frame depth - 5-7/8" Deep side frame

Table top chain - Tab style plastic low friction chain is included for the curve section only

Width - Overall width to be approximately size "B" (Reference picture-this page)

Curve Wear Strips - Returns and wear strips are included (Reference picture - this page).

*Outer curve wear strip is UHMW.

*Inner curve wear strip is lubricated UHMW. For speeds up to 150 F.P.M.

*Inner curve wear strip is Nylatron. For speeds over 150 F.P.M.

*Returns and wear strips are included (Reference picture - this page).

Radius Dimension - Radius is measured to centerline of chain.

How To Order

Model: **X-X XXX-XXX-XX**

- Component series (T) Table Top
- (S) Is placed here for Stainless Steel construction
- Table Top chain widths:
 - (325) = 3 1/4" wide
 - (450) = 4 1/2" wide
 - (750) = 7 1/2" wide
 - (1000) = 10" wide
 - (1200) = 12" wide
- Paint color (Leave blank if Stainless Steel)
 - (01) Blue
 - (02) Crème
 - (03) Safety Yellow
 - (04) Safety Orange
 - (05) Medium Metallic Grey
 - (06) White
 - (07) Dark Blue
- Degree of Curve
 - (15C) 15 degree Curve
 - (30C) 30 degree Curve
 - (45C) 45 degree Curve
 - (60C) 60 degree Curve
 - (90C) 90 degree Curve

How To Order

Supports - Floor supports are **not included** with the curve section (Reference Conveyor Accessories catalog)

Guiderails - Guiderails are **not included** (Reference Conveyor Accessories catalog)

Hardware - All connecting plates and fasteners are included for one end. Additional mounting plates are available at an additional cost.

TABLE TOP 60° CURVE SELECTION

"T" SERIES

Description

Utilizing side-flexing chain these curve sections enable continuous direction changing motion without additional dead plates or drives.

Applications

- Accumulating light duty cartons, Pouches, bags, cans, bottles, etc.
- Minimum back pressure
- Economical

60° Curve			
Part #	"A"	"B"	"C"
T-325-60C	0'-3 1/4"	0'-4 1/2"	24" Rad.
T-S325-60C			
T-450-60C	0'-4 1/2"	0'-5 1/4"	
T-S450-60C			
T-750-60C	0'-7 1/2"	0'-8 1/4"	
T-S-750-60C			
T-1000-60C	0'-10"	0'-10 3/4"	
T-S1000-60C			
T-1200-60C	1'-0"	1'-0 3/4"	
T-S1200-60C			

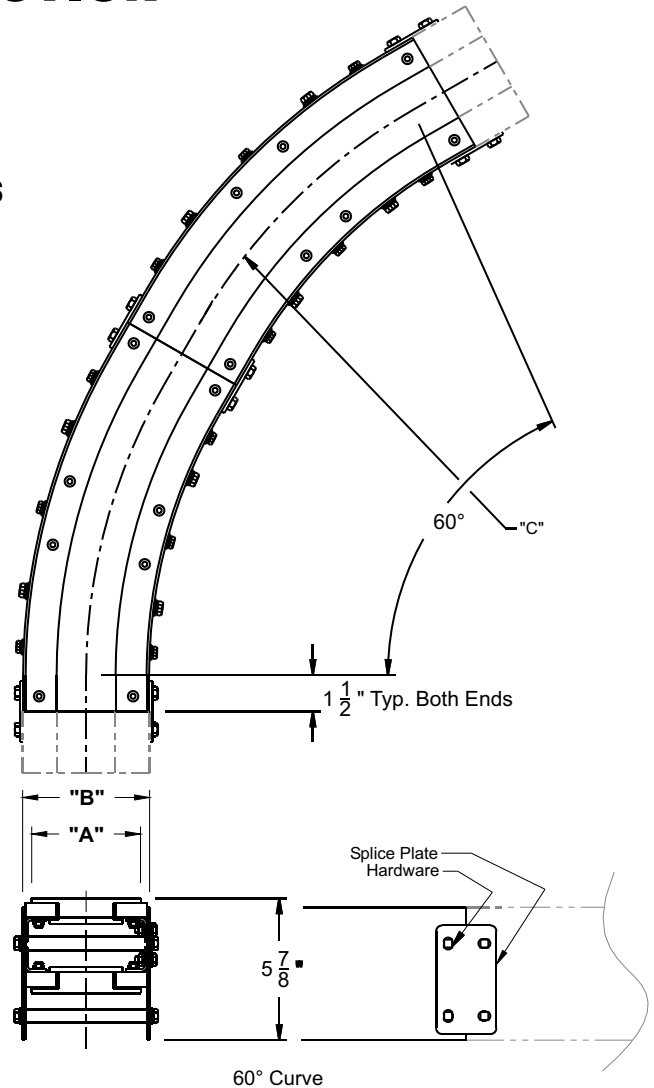

Standard Specifications:

Bed (Painted) - Standard Open design 11 ga. mild steel (Reference picture-this page)

Bed (Stainless Steel) - Standard Open design 12 ga. stainless steel (Reference picture-this page)

Side frame depth - 5-7/8" Deep side frame

Table top chain - Tab style plastic low friction chain is included for the curve section only

Width - Overall width to be approximately size "B" (Reference picture-this page)

Curve Wear Strips - Returns and wear strips are included (Reference picture - this page).

*Outer curve wear strip is UHMW.

*Inner curve wear strip is lubricated UHMW. For speeds up to 150 F.P.M.

*Inner curve wear strip is Nylatron. For speeds over 150 F.P.M.

*Returns and wear strips are included (Reference picture - this page).

Radius Dimension - Radius is measured to centerline of chain.

How To Order

Model: **X-X XXX-XXX-XX**

- Component series (T) Table Top
- (S) Is placed here for Stainless Steel construction
- Table Top chain widths:
 - (325) = 3 1/4" wide
 - (450) = 4 1/2" wide
 - (750) = 7 1/2" wide
 - (1000) = 10" wide
 - (1200) = 12" wide
- Paint color (Leave blank if Stainless Steel)
 - (01) Blue
 - (02) Crème
 - (03) Safety Yellow
 - (04) Safety Orange
 - (05) Medium Metallic Grey
 - (06) White
 - (07) Dark Blue
- Degree of Curve
 - (15C) 15 degree Curve
 - (30C) 30 degree Curve
 - (45C) 45 degree Curve
 - (60C) 60 degree Curve
 - (90C) 90 degree Curve

How To Order

Supports - Floor supports are **not included** with the curve section (Reference Conveyor Accessories catalog)

Guiderails - Guiderails are **not included** (Reference Conveyor Accessories catalog)

Hardware - All connecting plates and fasteners are included for one end. Additional mounting plates are available at an additional cost.

TABLE TOP 90° CURVE SELECTION

“T” SERIES

Description

Utilizing side-flexing chain these curve sections enable continuous direction changing motion without additional dead plates or drives.

Applications

- Accumulating light duty cartons, Pouches, bags, cans, bottles, etc.
- Minimum back pressure
- Economical

90° Curve			
Part #	"A"	"B"	"C"
T-325-90C	0'-3 1/4"	0'-4 1/2"	24" Rad.
T-S325-90C			
T-450-90C	0'-4 1/2"	0'-5 1/4"	
T-S450-90C			
T-750-90C	0'-7 1/2"	0'-8 1/4"	
T-S-750-90C			
T-1000-90C	0'-10"	0'-10 3/4"	
T-S1000-90C			
T-1200-90C	1'-0"	1'-0 3/4"	
T-S1200-90C			

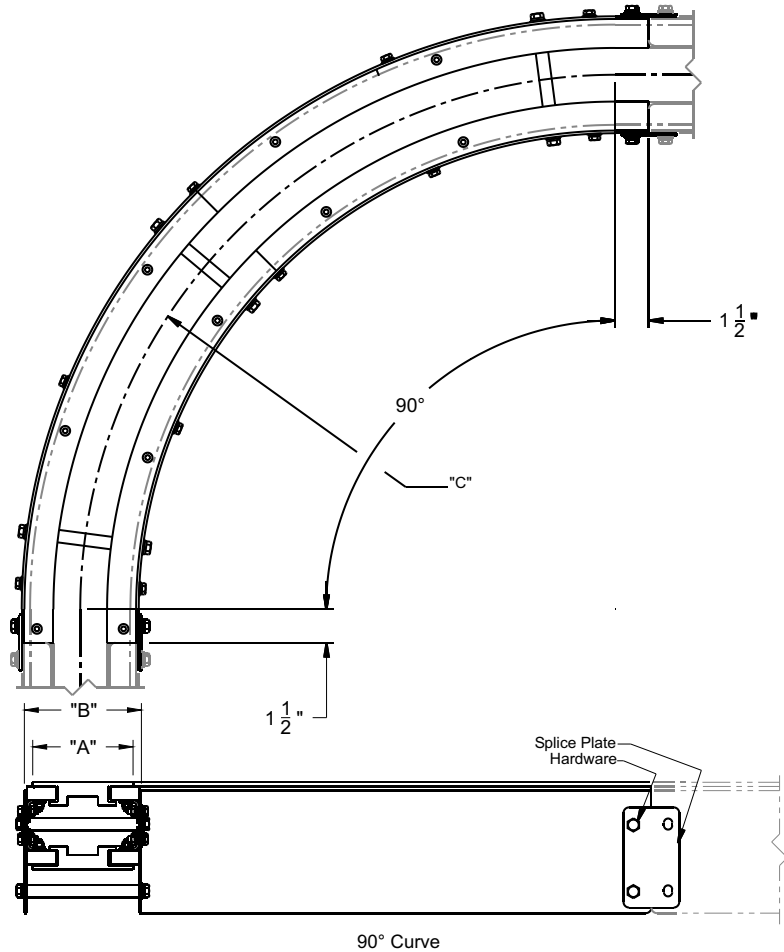

Standard Specifications:

Bed (Painted) - Standard Open design 11 ga. mild steel (Reference picture-this page)

Bed (Stainless Steel) - Standard Open design 12 ga. stainless steel (Reference picture-this page)

Side frame depth - 5-7/8" Deep side frame

Table top chain - Tab style plastic low friction chain is included for the curve section only

Width - Overall width to be approximately size "B" (Reference picture-this page)

Curve Wear Strips - Returns and wear strips are included (Reference picture - this page).

*Outer curve wear strip is UHMW.

*Inner curve wear strip is lubricated UHMW. For speeds up to 150 F.P.M.

*Inner curve wear strip is Nylatron. For speeds over 150 F.P.M.

*Returns and wear strips are included (Reference picture - this page).

Radius Dimension - Radius is measured to centerline of chain.

How To Order

Model: **X-X XXX-XXX-XX**

- Component series (T) Table Top
- (S) Is placed here for Stainless Steel construction
- Table Top chain widths:
 - (325) = 3 1/4" wide
 - (450) = 4 1/2" wide
 - (750) = 7 1/2" wide
 - (1000) = 10" wide
 - (1200) = 12" wide
- Paint color (Leave blank if Stainless Steel)
 - (01) Blue
 - (02) Crème
 - (03) Safety Yellow
 - (04) Safety Orange
 - (05) Medium Metallic Grey
 - (06) White
 - (07) Dark Blue
- Degree of Curve
 - (15C) 15 degree Curve
 - (30C) 30 degree Curve
 - (45C) 45 degree Curve
 - (60C) 60 degree Curve
 - (90C) 90 degree Curve

How To Order

Supports - Floor supports are **not included** with the curve section (Reference Conveyor Accessories catalog)

Guiderails - Guiderails are **not included** (Reference Conveyor Accessories catalog)

Hardware - All connecting plates and fasteners are included for one end. Additional mounting plates are available at an additional cost.

MAT TOP INTERMEDIATE SECTION

"M-900" SERIES

Description

The intermediate section transports product between the Drive and Idle Assemblies

Applications

- Accumulating Cases, cartons, Pouches, bags, cans, bottles, etc.
- Minimum back pressure
- Economical

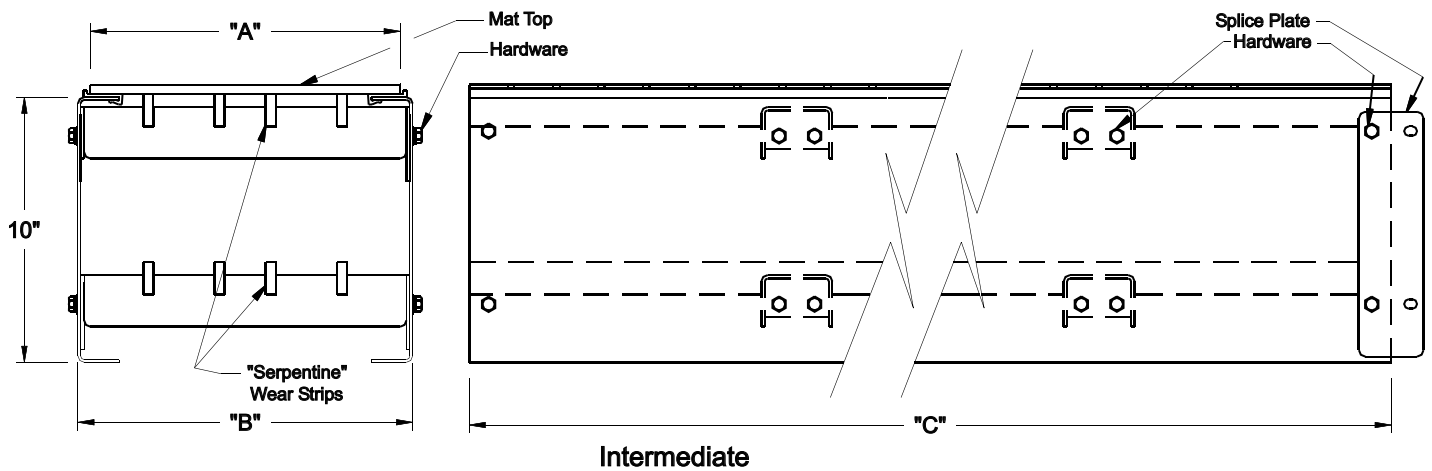

Standard Specifications:

Bed (Painted) - Standard Open design 11 ga. mild steel (Reference picture-this page)

Bed (Stainless Steel) - Standard Open design 12 ga. stainless steel (Reference picture-this page)

Side frame depth: 10" Deep side frame

Mat top chain: Open grid plastic (Polypropylene) low friction 38% open chain (FDA/USDA approved) is included for the intermediate section only

Width: Overall width to be approximately size "B" (Reference picture-this page)

Supports: Floor supports are **not included** with the intermediate (Reference Conveyor Accessories catalog)

Drive package: Standard drive package available (Reference drive section)

Guiderails: Guiderails are **not included** (Reference Conveyor Accessories catalog)

Wear strips: Returns and wear strips are included (Reference picture-this page)

Hardware: All connecting plates and fasteners are included for one end. Additional mounting plates are available at an addition cost.

1'-0" Intermediate			
Part #	"A"	"B"	"C"
M-912-12	1'-0"	1'-0 3/4"	1'-0"
M-S912-12			
M-918-12	1'-6"	1'-6 3/4"	
M-S918-12			
M-924-12	2'-0"	2'-0 3/4"	
M-S924-12			
M-930-12	2'-6"	2'-6 3/4"	
M-S930-12			
M-936-12	3'-0"	3'-0 3/4"	
M-S936-12			
M-S942-12	3'-6"	3'-6 3/4"	
M-S942-12			
M-S948-12	4'-0"	4'-0 3/4"	
M-S948-12			

2'-0" Intermediate			
Part #	"A"	"B"	"C"
M-912-24	1'-0"	1'-0 3/4"	2'-0"
M-S912-24			
M-918-24	1'-6"	1'-6 3/4"	
M-S918-24			
M-924-24	2'-0"	2'-0 3/4"	
M-S924-24			
M-930-24	2'-6"	2'-6 3/4"	
M-S930-24			
M-936-24	3'-0"	3'-0 3/4"	
M-S936-24			
M-S942-24	3'-6"	3'-6 3/4"	
M-S942-24			
M-S948-24	4'-0"	4'-0 3/4"	
M-S948-24			

3'-0" Intermediate			
Part #	"A"	"B"	"C"
M-912-36	1'-0"	1'-0 3/4"	3'-0"
M-S912-36			
M-918-36	1'-6"	1'-6 3/4"	
M-S918-36			
M-924-36	2'-0"	2'-0 3/4"	
M-S924-36			
M-930-36	2'-6"	2'-6 3/4"	
M-S930-36			
M-936-36	3'-0"	3'-0 3/4"	
M-S936-36			
M-S942-36	3'-6"	3'-6 3/4"	
M-S942-36			
M-S948-36	4'-0"	4'-0 3/4"	
M-S948-36			

4'-0" Intermediate			
Part #	"A"	"B"	"C"
M-912-48	1'-0"	1'-0 3/4"	4'-0"
M-S912-48			
M-918-48	1'-6"	1'-6 3/4"	
M-S918-48			
M-924-48	2'-0"	2'-0 3/4"	
M-S924-48			
M-930-48	2'-6"	2'-6 3/4"	
M-S930-48			
M-936-48	3'-0"	3'-0 3/4"	
M-S936-48			
M-942-48	3'-6"	3'-6 3/4"	
M-S942-48			
M-948-48	4'-0"	4'-0 3/4"	
M-S948-48			

5'-0" Intermediate			
Part #	"A"	"B"	"C"
M-912-60	1'-0"	1'-0 3/4"	5'-0"
M-S912-60			
M-918-60	1'-6"	1'-6 3/4"	
M-S918-60			
M-924-60	2'-0"	2'-0 3/4"	
M-S924-60			
M-930-60	2'-6"	2'-6 3/4"	
M-S930-60			
M-936-60	3'-0"	3'-0 3/4"	
M-S936-60			
M-S942-60	3'-6"	3'-6 3/4"	
M-S942-60			
M-S948-60	4'-0"	4'-0 3/4"	
M-S948-60			

6'-0" Intermediate			
Part #	"A"	"B"	"C"
M-912-72	1'-0"	1'-0 3/4"	6'-0"
M-S912-72			
M-918-72	1'-6"	1'-6 3/4"	
M-S918-72			
M-924-72	2'-0"	2'-0 3/4"	
M-S924-72			
M-930-72	2'-6"	2'-6 3/4"	
M-S930-72			
M-936-72	3'-0"	3'-0 3/4"	
M-S936-72			
M-S942-72	3'-6"	3'-6 3/4"	
M-S942-72			
M-S948-72	4'-0"	4'-0 3/4"	
M-S948-72			

7'-0" Intermediate			
Part #	"A"	"B"	"C"
M-912-84	1'-0"	1'-0 3/4"	7'-0"
M-S912-84			
M-918-84	1'-6"	1'-6 3/4"	
M-S918-84			
M-924-84	2'-0"	2'-0 3/4"	
M-S924-84			
M-930-84	2'-6"	2'-6 3/4"	
M-S930-84			
M-936-84	3'-0"	3'-0 3/4"	
M-S936-84			
M-S942-84	3'-6"	3'-6 3/4"	
M-S942-84			
M-S948-84	4'-0"	4'-0 3/4"	
M-S948-84			

8'-0" Intermediate			
Part #	"A"	"B"	"C"
M-912-96	1'-0"	1'-0 3/4"	8'-0"
M-S912-96			
M-918-96	1'-6"	1'-6 3/4"	
M-S918-96			
M-924-96	2'-0"	2'-0 3/4"	
M-S924-96			
M-930-96	2'-6"	2'-6 3/4"	
M-S930-96			
M-936-96	3'-0"	3'-0 3/4"	
M-S936-96			
M-S942-96	3'-6"	3'-6 3/4"	
M-S942-96			
M-S948-96	4'-0"	4'-0 3/4"	
M-S948-96			

9'-0" Intermediate			
Part #	"A"	"B"	"C"
M-912-108	1'-0"	1'-0 3/4"	9'-0"
M-S912-108			
M-918-108	1'-6"	1'-6 3/4"	
M-S918-108			
M-924-108	2'-0"	2'-0 3/4"	
M-S924-108			
M-930-108	2'-6"	2'-6 3/4"	
M-S930-108			
M-936-108	3'-0"	3'-0 3/4"	
M-S936-108			
M-S942-108	3'-6"	3'-6 3/4"	
M-S942-108			
M-S948-108	4'-0"	4'-0 3/4"	
M-S948-108			

10'-0" Intermediate			
Part #	"A"	"B"	"C"
M-912-120	1'-0"	1'-0 3/4"	10'-0"
M-S912-120			
M-918-120	1'-6"	1'-6 3/4"	
M-S918-120			
M-924-120	2'-0"	2'-0 3/4"	
M-S924-120			
M-930-120	2'-6"	2'-6 3/4"	
M-S930-120			
M-936-120	3'-0"	3'-0 3/4"	
M-S936-120			
M-942-120	3'-6"	3'-6 3/4"	
M-S942-120			
M-948-120	4'-0"	4'-0 3/4"	
M-S948-120			

How To Order

Model: **X-X X XX XXX-XX**

Component series
(M) Mat Top
(S) Is placed here for Stainless Steel construction

Mat Top chain series:
(9) = Series 900
(11) = Series 1100
(24) = Series 2400

Mat Top chain widths:
(12) = 12" or 1'-0" wide
(18) = 18" or 1'-6" wide
(24) = 24" or 2'-0" wide
(30) = 30" or 2'-6" wide
(36) = 36" or 3'-0" wide
(42) = 42" or 3'-6" wide
(48) = 48" or 4'-0" wide

Paint color (Leave blank if Stainless Steel)
(01) Blue
(02) Crème
(03) Safety Yellow
(04) Safety Orange
(05) Medium Metallic Grey
(06) White
(07) Dark Blue

Actual length of intermediate (example: 12 = 1'-0") Refer to selection tables for correct lengths

How To Order

MAT TOP DRIVE SECTION

“M-900” SERIES

Description

The **DRIVE END** is the portion of conveyor where the motor is located. The product transport chain ends at this location and becomes the return chain as it recirculates.

Applications

- Accumulating Cases, cartons, Pouches, bags, cans, bottles, etc.
- Minimum back pressure
- Economical

Drive Mounted High			
Part #	“A”	“B”	“C”
M-912-DLH	1' - 0"	1-6 3/4"	3'-0"
M-912-DRH			
M-S912-DLH			
M-S912-DRH			
M-918-DLH	1' - 6"	2'-0 3/4"	
M-918-DRH			
M-S918-DLH			
M-S918-DRH			
M-924-DLH	2' - 0"	2'-6 3/4"	
M-924-DRH			
M-S924-DLH			
M-S924-DRH			
M-930-DLH	2' - 6"	3'-0 3/4"	
M-930-DRH			
M-S930-DLH			
M-S930-DRH			
M-936-DLH	3' - 0"	3'-6 3/4"	
M-936-DRH			
M-S936-DLH			
M-S936-DRH			
M-942-DLH	3' - 6"	4'-0 3/4"	
M-942-DRH			
M-S942-DLH			
M-S942-DRH			
M-948-DLH	4' - 0"	4'-6 3/4"	
M-948-DRH			
M-S948-DLH			
M-S948-DRH			

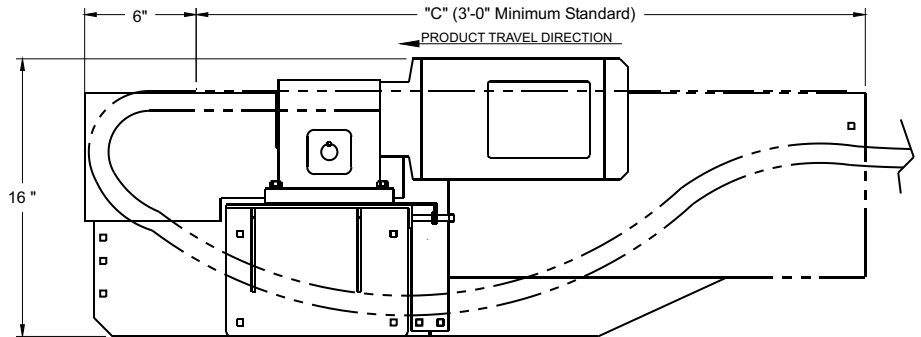
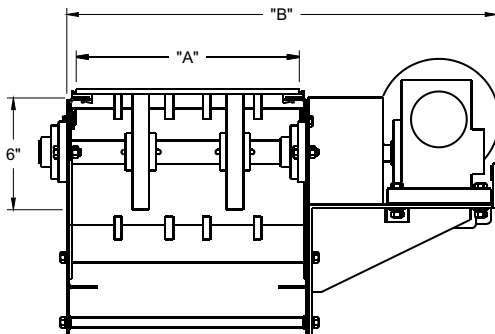

Drive Mounted High (Left Hand Shown)

Standard Specifications:

Bed (Painted) - Standard Open design 11 ga. mild steel (Reference picture-this page)

Bed (Stainless Steel) - Standard Open design 12 ga. stainless steel (Reference picture-this page)

Side frame depth - 15 " Deep side frame (Drive end)

Mat top chain - Open grid plastic (Polypropylene) low friction 38% open chain (FDA/USDA approved) is included for the drive section only

Width - Overall width to be approximately size "B" (Reference picture-this page for drive mounted high, Reference pictures next page for drives mounted low and center)

Supports - Floor supports are **not included** with the drive section (Reference Conveyor Accessories catalog)

Transfers - End to end transfers are **not included** (Reference Conveyor Accessories catalog)

Drive package - UP to 1 hp 208-230-4603/60 motor std. Larger horsepower motor are available. Fixed speed between 50 and 200 F.P.M. (Specify) (Reference speed selection section)

Guiderails - Guiderails are **not included** (Reference Conveyor Accessories catalog)

Wear strip - Returns and wear strips are included (Reference picture-this page)

Hardware - All connecting plates and fasteners are included for one end. Additional mounting plates are available at an additional cost.

Electrical - Electrical connections are **not included** (Reference Controls Accessories catalog)

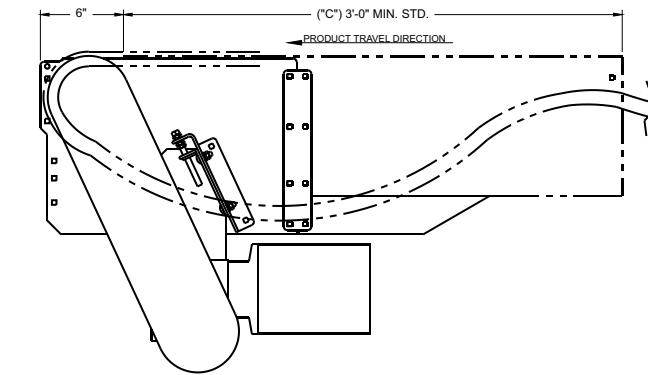
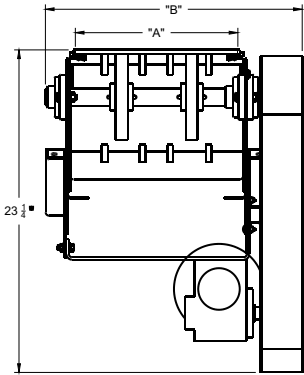

Drive mounted Low (Left Hand Shown)

Drive Mounted Low

Part #	"A"	"B"	"C"
M-912-DLU			
M-912-DRU			
M-S912-DLU	1' - 0"	1-6 3/4"	
M-S912-DRU			
M-918-DLU			
M-918-DRU	1' - 6"	2'-0 3/4"	
M-S918-DLU			
M-S918-DRU			
M-924-DLU			
M-924-DRU	2' - 0"	2'-6 3/4"	
M-S924-DLU			
M-S924-DRU			
M-930-DLU			
M-930-DRU	2' - 6"	3'-0 3/4"	3'-0"
M-S930-DLU			
M-S930-DRU			
M-936-DLU			
M-936-DRU	3' - 0"	3'-6 3/4"	
M-S936-DLU			
M-S936-DRU			
M-942-DLU			
M-942-DRU	3' - 6"	4'-0 3/4"	
M-S942-DLU			
M-S942-DRU			
M-948-DLU			
M-948-DRU	4' - 0"	4'-6 3/4"	
M-S948-DLU			
M-S948-DRU			

How To Order

Model: X-X XX-XX-XXX-XX-XX-XXX

- Component series (M) Mat Top
- (S) Is placed here for Stainless Steel construction
- Mat Top chain series:
 - (9) = Series 900
 - (11) = Series 1100
 - (24) = Series 2400
- Mat Top chain widths:
 - (12) = 12" or 1'-0" wide
 - (18) = 18" or 1'-6" wide
 - (24) = 24" or 2'-0" wide
 - (30) = 30" or 2'-6" wide
 - (36) = 36" or 3'-0" wide
 - (42) = 42" or 3'-6" wide
 - (48) = 48" or 4'-0" wide
- Denotes F.P.M. (Feet Per Minute) requirements. Refer to selection tables for correct F.P.M. (example: 150 = 150 F.P.M.)
- Denotes horse power requirements:
 - (05) 1/2 HP (Included In Standard pricing)
 - (75) 3/4 HP (Add to std. price)
 - (10) 1 HP (Add to std. price)
 - (15) 1 1/2 HP (Add to std. price)
- Paint color (Leave blank if Stainless Steel)
 - (01) Blue
 - (02) Crème
 - (03) Safety Yellow
 - (04) Safety Orange
 - (05) Medium Metallic Grey
 - (06) White
 - (07) Dark Blue
- Mat Top drive position:
 - (DLH) Drive, Left Hand, Mounted High
 - (DRH) Drive, Right Hand, Mounted High
 - (DLU) Drive, Left Hand, Mounted Low
 - (DRU) Drive, Right Hand, Mounted Low
 - (DLC) Drive, Left Hand, Mounted Low
 - (DRC) Drive, Right Hand, Mounted Low

How To Order

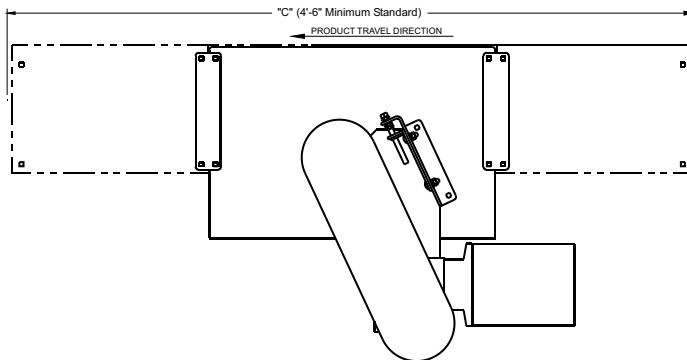
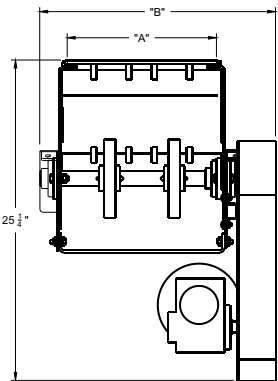

Drive Mounted Low Center (Left Hand Shown)

Drive Mounted Center

Part #	"A"	"B"	"C"
M-912-DLC			
M-912-DRC			
M-S912-DLC	1' - 0"	1-6 3/4"	
M-S912-DRC			
M-918-DLC			
M-918-DRC	1' - 6"	2'-0 3/4"	
M-S918-DLC			
M-S918-DRC			
M-924-DLC			
M-924-DRC	2' - 0"	2'-6 3/4"	
M-S924-DLC			
M-S924-DRC			
M-930-DLC			
M-930-DRC	2' - 6"	3'-0 3/4"	3'-0"
M-S930-DLC			
M-S930-DRC			
M-936-DLC			
M-936-DRC	3' - 0"	3'-6 3/4"	
M-S936-DLC			
M-S936-DRC			
M-942-DLC			
M-942-DRC	3'-6 "	4'-0 3/4"	
M-S942-DLC			
M-S942-DRC			
M-948-DLC			
M-948-DRC	4' - 0"	4'-6 3/4"	
M-S948-DLC			
M-S948-DRC			

MAT TOP IDLER / TAIL SECTION

"M-900" SERIES

Description

The IDLER END is the portion of conveyor opposing the DRIVE END. The returning chain as it recirculates becomes the product transport chain at this point.

Applications

- Accumulating cases, cartons, Pouches, bags, cans, bottles, etc.
- Minimum back pressure
- Economical

Idler / End Section			
Part #	"A"	"B"	"C"
M-912-T	1' - 0"	1-6"	3'-0"
M-S912-T			
M-918-T	1' - 6"		
M-S918-T			
M-924-T	2' - 0"		
M-S924-T			
M-930-T	2' - 6"		
M-S930-T			
M-936-T	3' - 0"		
M-S936-T			
M-942-T	3' - 6"		
M-S942-T			
M-948-T	4' - 0"		
M-S-948-T			

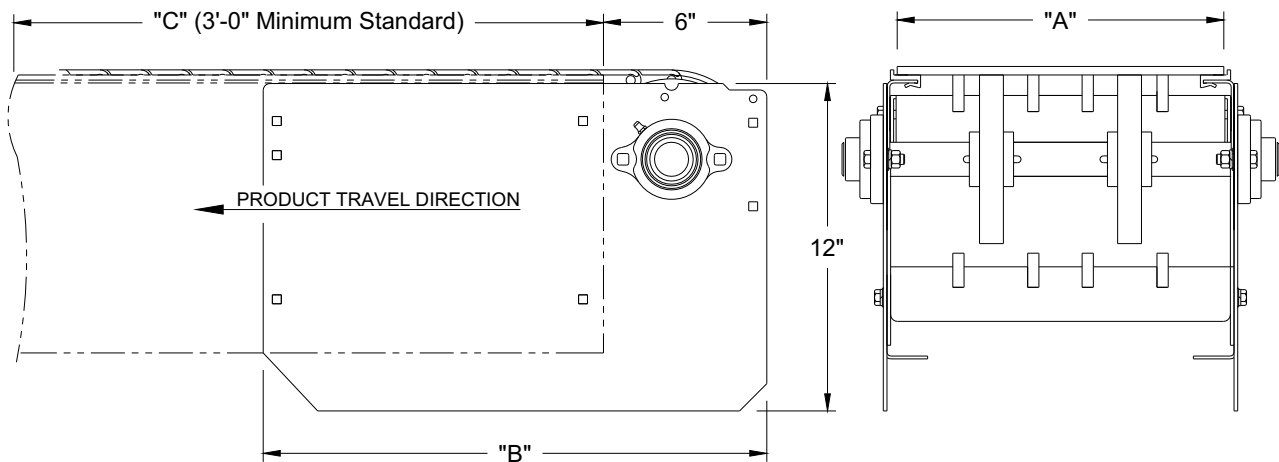

Standard Specifications:

Bed (Painted) - Standard Open design 11 ga. mild steel (Reference picture-this page)

Bed (Stainless Steel) - Standard Open design 12 ga. stainless steel (Reference-this page)

Side frame depth - 12" Deep side frame

Mat top chain - Open grid plastic (Polypropylene) low friction 38% open chain (FDA/USDA approved) is included for the Idler/Tail end only

Width - Overall width to be approximately size "B" (Reference picture-this page)

Supports - Floor supports are **not included** with the Idler/Tail (Reference Conveyor Accessories catalog)

Transfers - End to end transfers are **not included** (Reference Conveyor Accessories catalog)

Guiderails - Guiderails are **not included** (Reference Conveyor Accessories catalog)

Wear strip - Returns and wear strips are included (Reference picture-this page)

Hardware - All connecting plates and fasteners are included for one end. Additional mounting plates are available at an additional cost.

How To Order

Model: **X-X X XX-X-XX**

<p>Component series</p> <p>(M) Mat Top</p> <p>(S) Is placed here for Stainless Steel construction</p> <p>Mat Top chain series:</p> <p>(9) = Series 900</p> <p>(11) = Series 1100</p> <p>(24) = Series 2400</p> <p>Mat Top chain widths:</p> <p>(12) = 12" or 1'-0" wide</p> <p>(18) = 18" or 1'-6" wide</p> <p>(24) = 24" or 2'-0" wide</p> <p>(30) = 30" or 2'-6" wide</p> <p>(36) = 36" or 3'-0" wide</p> <p>(42) = 42" or 3'-6" wide</p> <p>(48) = 48" or 4'-0" wide</p>	<p>Paint color (Leave blank if Stainless Steel)</p> <p>(01) Blue</p> <p>(02) Crème</p> <p>(03) Safety Yellow</p> <p>(04) Safety Orange</p> <p>(05) Medium Metallic Grey</p> <p>(06) White</p> <p>(07) Dark Blue</p> <p>(T) Is placed here for Tail Section (Idler End)</p>
-----------------------------------------------------------------------------------------------------------------------------------------------------------------------------------------------------------------------------------------------------------------------------------------------------------------------------------------------------------------------------------------------------------------------------------------------------------------------------	----------------------------------------------------------------------------------------------------------------------------------------------------------------------------------------------------------------------------------------------------------------------------

How To Order

MAT TOP INTERMEDIATE SECTION

“M-1100” SERIES

Description

The intermediate section transports product between the Drive and Idle Assemblies

Applications

- Accumulating cases, cartons, Pouches, bags, cans, bottles, etc.
- Minimum back pressure
- Economical

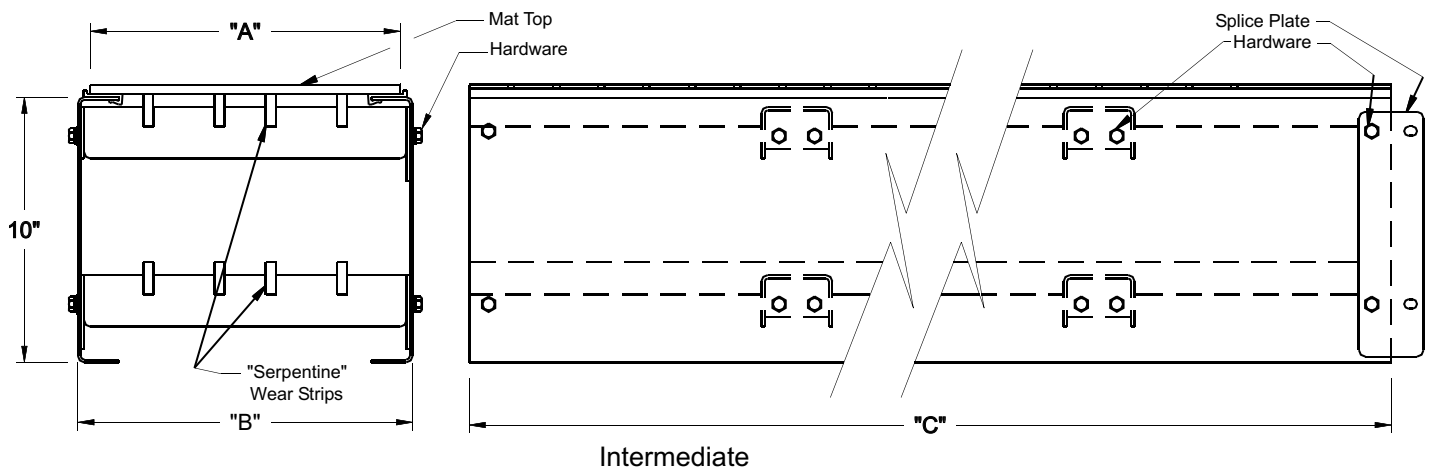

Standard Specifications:

Bed (Painted) - Standard Open design 11 ga. mild steel (Reference picture-this page)

Bed (Stainless Steel) - Standard Open design 12 ga. stainless steel (Reference picture-this page)

Side frame depth: 10" Deep side frame

Mat top chain: Open grid plastic (Polypropylene) low friction 28% open chain (FDA/USDA approved) is included for the intermediate section only

Width: Overall width to be approximately size "B" (Reference picture-this page)

Supports: Floor supports are **not included** with the intermediate (Reference Conveyor Accessories catalog)

Drive package: Standard drive package available (Reference drive section)

Guiderails: Guiderails are not included (Reference Conveyor Accessories catalog)

Wear strips: Returns and wear strips are included (Reference picture-this page)

Hardware: All connecting plates and fasteners are included for one end. Additional mounting plates are available at an addition cost.

1'-0" Intermediate			
Part #	"A"	"B"	"C"
M-1112-12	1'-0"	1'-0 3/4"	1'-0"
M-S1112-12			
M-1118-12	1'-6"	1'-6 3/4"	
M-S1118-12			
M-1124-12	2'-0"	2'-0 3/4"	
M-S1124-12			
M-1130-12	2'-6"	2'-6 3/4"	
M-S1130-12			
M-1136-12	3'-0"	3'-0 3/4"	
M-S1136-12			
M-1142-12	3'-6"	3'-6 3/4"	
M-S1142-12			
M-1148-12	4'-0"	4'-0 3/4"	
M-S1148-12			

2'-0" Intermediate			
Part #	"A"	"B"	"C"
M-1112-24	1'-0"	1'-0 3/4"	2'-0"
M-S1112-24			
M-1118-24	1'-6"	1'-6 3/4"	
M-S1118-24			
M-1124-24	2'-0"	2'-0 3/4"	
M-S1124-24			
M-1130-24	2'-6"	2'-6 3/4"	
M-S1130-24			
M-1136-24	3'-0"	3'-0 3/4"	
M-S1136-24			
M-1142-24	3'-6"	3'-6 3/4"	
M-S1142-24			
M-1148-24	4'-0"	4'-0 3/4"	
M-S1148-24			

3'-0" Intermediate			
Part #	"A"	"B"	"C"
M-1112-36	1'-0"	1'-0 3/4"	3'-0"
M-S1112-36			
M-1118-36	1'-6"	1'-6 3/4"	
M-S1118-36			
M-1124-36	2'-0"	2'-0 3/4"	
M-S1124-36			
M-1130-36	2'-6"	2'-6 3/4"	
M-S1130-36			
M-1136-36	3'-0"	3'-0 3/4"	
M-S1136-36			
M-1142-36	3'-6"	3'-6 3/4"	
M-S1142-36			
M-1148-36	4'-0"	4'-0 3/4"	
M-S1148-36			

4'-0" Intermediate			
Part #	"A"	"B"	"C"
M-1112-48	1'-0"	1'-0 3/4"	4'-0"
M-S1112-48			
M-1118-48	1'-6"	1'-6 3/4"	
M-S1118-48			
M-1124-48	2'-0"	2'-0 3/4"	
M-S1124-48			
M-1130-48	2'-6"	2'-6 3/4"	
M-S1130-48			
M-1136-48	3'-0"	3'-0 3/4"	
M-S1136-48			
M-1142-48	3'-6"	3'-6 3/4"	
M-S1142-48			
M-1148-48	4'-0"	4'-0 3/4"	
M-S1148-48			

5'-0" Intermediate			
Part #	"A"	"B"	"C"
M-1112-60	1'-0"	1'-0 3/4"	5'-0"
M-S1112-60			
M-1118-60	1'-6"	1'-6 3/4"	
M-S1118-60			
M-1124-60	2'-0"	2'-0 3/4"	
M-S1124-60			
M-1130-60	2'-6"	2'-6 3/4"	
M-S1130-60			
M-1136-60	3'-0"	3'-0 3/4"	
M-S1136-60			
M-1142-60	3'-6"	3'-6 3/4"	
M-S1142-60			
M-1148-60	4'-0"	4'-0 3/4"	
M-S1148-60			

6'-0" Intermediate			
Part #	"A"	"B"	"C"
M-1112-72	1'-0"	1'-0 3/4"	6'-0"
M-S1112-72			
M-1118-72	1'-6"	1'-6 3/4"	
M-S1118-72			
M-1124-72	2'-0"	2'-0 3/4"	
M-S1124-72			
M-1130-72	2'-6"	2'-6 3/4"	
M-S1130-72			
M-1136-72	3'-0"	3'-0 3/4"	
M-S1136-72			
M-1142-72	3'-6"	3'-6 3/4"	
M-S1142-72			
M-1148-72	4'-0"	4'-0 3/4"	
M-S1148-72			

7'-0" Intermediate			
Part #	"A"	"B"	"C"
M-1112-84	1'-0"	1'-0 3/4"	7'-0"
M-S1112-84			
M-1118-84	1'-6"	1'-6 3/4"	
M-S1118-84			
M-1124-84	2'-0"	2'-0 3/4"	
M-S1124-84			
M-1130-84	2'-6"	2'-6 3/4"	
M-S1130-84			
M-1136-84	3'-0"	3'-0 3/4"	
M-S1136-84			
M-1142-84	3'-6"	3'-6 3/4"	
M-S1142-84			
M-1148-84	4'-0"	4'-0 3/4"	
M-S1148-84			

8'-0" Intermediate			
Part #	"A"	"B"	"C"
M-1112-96	1'-0"	1'-0 3/4"	8'-0"
M-S1112-96			
M-1118-96	1'-6"	1'-6 3/4"	
M-S1118-96			
M-1124-96	2'-0"	2'-0 3/4"	
M-S1124-96			
M-1130-96	2'-6"	2'-6 3/4"	
M-S1130-96			
M-1136-96	3'-0"	3'-0 3/4"	
M-S1136-96			
M-1142-96	3'-6"	3'-6 3/4"	
M-S1142-96			
M-1148-96	4'-0"	4'-0 3/4"	
M-S1148-96			

9'-0" Intermediate			
Part #	"A"	"B"	"C"
M-1112-108	1'-0"	1'-0 3/4"	9'-0"
M-S1112-108			
M-1118-108	1'-6"	1'-6 3/4"	
M-S1118-108			
M-1124-108	2'-0"	2'-0 3/4"	
M-S1124-108			
M-1130-108	2'-6"	2'-6 3/4"	
M-S1130-108			
M-1136-108	3'-0"	3'-0 3/4"	
M-S1136-108			
M-1142-108	3'-6"	3'-6 3/4"	
M-S1142-108			
M-1148-108	4'-0"	4'-0 3/4"	
M-S1148-108			

10'-0" Intermediate			
Part #	"A"	"B"	"C"
M-1112-120	1'-0"	1'-0 3/4"	10'-0"
M-S1112-120			
M-1118-120	1'-6"	1'-6 3/4"	
M-S1118-120			
M-1124-120	2'-0"	2'-0 3/4"	
M-S1124-120			
M-1130-120	2'-6"	2'-6 3/4"	
M-S1130-120			
M-1136-120	3'-0"	3'-0 3/4"	
M-S1136-120			
M-1142-120	3'-6"	3'-6 3/4"	
M-S1142-120			
M-1148-120	4'-0"	4'-0 3/4"	
M-S1148-120			

How To Order

Model: **X-X X XX XXX-XX**

Component series
(M) Mat Top
(S) Is placed here for Stainless Steel construction

Mat Top chain series:
(9) = Series 900
(11) = Series 1100
(24) = Series 2400

Mat Top chain widths:
(12) = 12" or 1'-0" wide
(18) = 18" or 1'-6" wide
(24) = 24" or 2'-0" wide
(30) = 30" or 2'-6" wide
(36) = 36" or 3'-0" wide
(42) = 42" or 3'-6" wide
(48) = 48" or 4'-0" wide

Paint color (Leave blank if Stainless Steel)
(01) Blue
(02) Crème
(03) Safety Yellow
(04) Safety Orange
(05) Medium Metallic Grey
(06) White
(07) Dark Blue

Actual length of intermediate (example: 12 = 1'-0") Refer to selection tables for correct lengths

How To Order

MAT TOP DRIVE SECTION

“M-1100” SERIES

Description

The **DRIVE END** is the portion of conveyor where the motor is located. The product transport chain ends at this location and becomes the return chain as it recirculates.

Applications

- Accumulating cases, cartons, Pouches, bags, cans, bottles, etc.
- Minimum back pressure
- Economical

Drive Mounted High			
Part #	“A”	“B”	“C”
M-1112-DLH			
M-1112-DRH	1' - 0"	1-11 1/8"	
M-S1112-DLH			
M-S1112-DRH			
M-1118-DLH			
M-1118-DRH	1' - 6"	2'-5 1/8"	
M-S1118-DLH			
M-S1118-DRH			
M-1124-DLH			
M-1124-DRH	2' - 0"	2'-11 1/8"	
M-S1124-DLH			
M-S1124-DRH			
M-1130-DLH			
M-1130-DRH	2' - 6"	3'-5 1/8"	3'-0"
M-S1130-DLH			
M-S1130-DRH			
M-1136-DLH			
M-1136-DRH	3' - 0"	3'-11 1/8"	
M-S1136-DLH			
M-S1136-DRH			
M-1142-DLH			
M-1142-DRH	3' - 6"	4'-5 1/8"	
M-S1142-DLH			
M-S1142-DRH			
M-1148-DLH			
M-1148-DRH	4' - 0"	4'-11 1/8"	
M-S1148-DLH			
M-S1148-DRH			

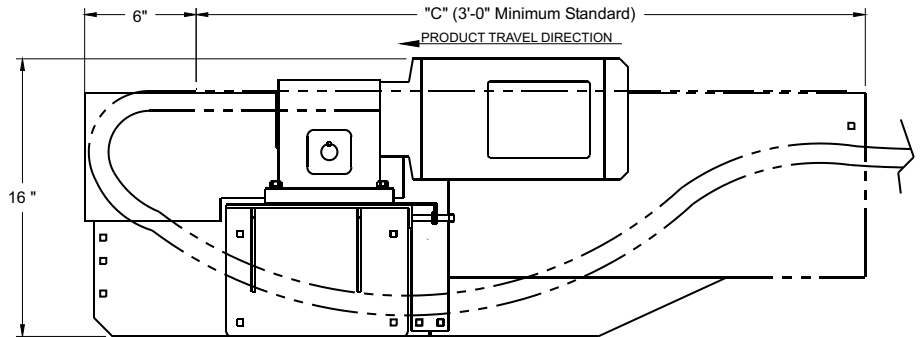
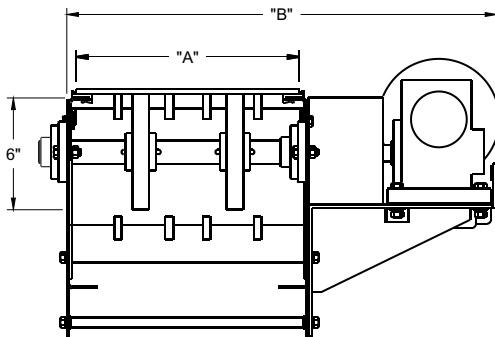

Drive Mounted High (Left Hand Shown)

Standard Specifications:

Bed (Painted) - Standard Open design 11 ga. mild steel (Reference picture-this page)

Bed (Stainless Steel) - Standard Open design 12 ga. stainless steel (Reference picture-this page)

Side frame depth - 15" Deep side frame (Drive end)

Mat top chain - Open grid plastic (Polypropylene) low friction 28% open chain (FDA/USDA approved) is included for the drive section only

Width - Overall width to be approximately size “B” (Reference picture-this page for drive mounted high, Reference pictures next page for drives mounted low and center)

Supports - Floor supports are **not included** with the drive (Reference Conveyor Accessories catalog)

Transfers - End to end transfers are **not included** (Reference Conveyor Accessories catalog)

Drive package - UP to 1 hp 208-230-4603/60 motor std. Larger horsepower motor are available. Fixed speed between 50 and 200 F.P.M. (Specify) (Reference speed selection section)

Guiderails - Guiderails are **not included** (Reference Conveyor Accessories catalog)

Wear strip - Returns and wear strips are included (Reference picture-this page)

Hardware - All connecting plates and fasteners are included for one end. Additional mounting plates are available at an additional cost.

Electrical - Electrical connections are **not included** (Reference Controls Accessories catalog)

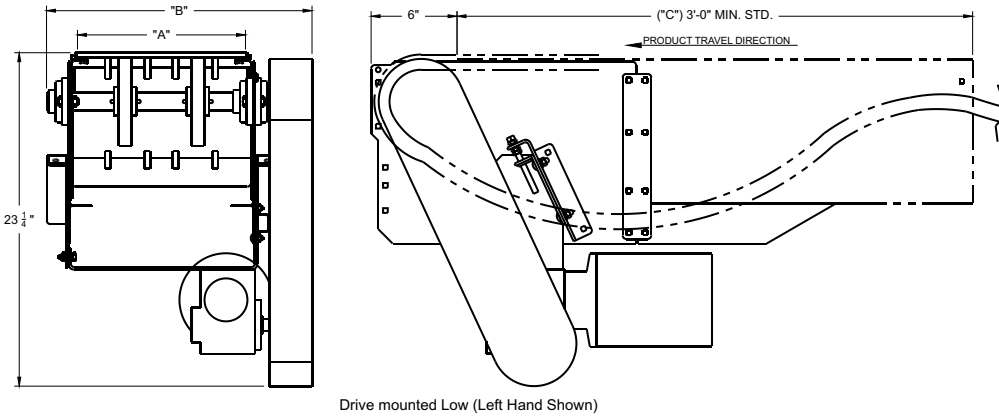

Drive mounted Low (Left Hand Shown)

How To Order

Model: X-X XX-XX-XXX-XX-XX-XXX

<p>Component series (M) Mat Top</p> <p>(S) Is placed here for Stainless Steel construction</p> <p>Mat Top chain series: (9) = Series 900 (11) = Series 1100 (24) = Series 2400</p> <p>Mat Top chain widths: (12) = 12" or 1'-0" wide (18) = 18" or 1'-6" wide (24) = 24" or 2'-0" wide (30) = 30" or 2'-6" wide (36) = 36" or 3'-0" wide (42) = 42" or 3'-6" wide (48) = 48" or 4'-0" wide</p>	<p>Denotes F.P.M. (Feet Per Minute) requirements. Refer to selection tables for correct F.P.M. (example: 150 = 150 F.P.M.)</p> <p>Denotes horse power requirements: (05) 1/2 HP (Included In Standard pricing) (75) 3/4 HP (Add to std. price) (10) 1 HP (Add to std. price) (15) 1 1/2 HP (Add to std. price)</p> <p>Paint color (Leave blank if Stainless Steel) (01) Blue (02) Crème (03) Safety Yellow (04) Safety Orange (05) Medium Metallic Grey (06) White (07) Dark Blue</p> <p>Mat Top drive position: (DLH) Drive, Left Hand, Mounted High (DRH) Drive, Right Hand, Mounted High (DLU) Drive, Left Hand, Mounted Low (DRU) Drive, Right Hand, Mounted Low (DLC) Drive, Left Hand, Mounted Low (DRC) Drive, Right Hand, Mounted Low</p>
--------------------------------------------------------------------------------------------------------------------------------------------------------------------------------------------------------------------------------------------------------------------------------------------------------------------------------------------------------------------------------------------------------------------------------------------	-----------------------------------------------------------------------------------------------------------------------------------------------------------------------------------------------------------------------------------------------------------------------------------------------------------------------------------------------------------------------------------------------------------------------------------------------------------------------------------------------------------------------------------------------------------------------------------------------------------------------------------------------------------------------------------------------------------------------------------------------------------------------------------------------------------------------

How To Order

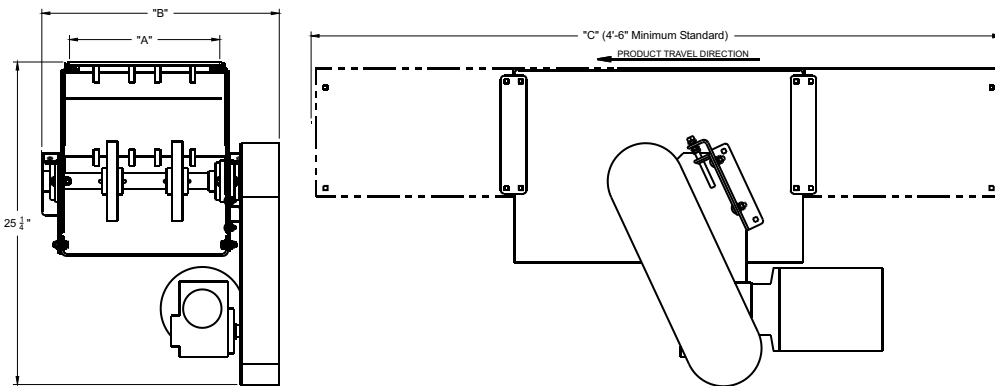

Drive Mounted Low Center (Left Hand Shown)

Drive Mounted Low

Part #	"A"	"B"	"C"
M-1112-DLU			
M-1112-DRU	1' - 0"	1-6 3/4"	
M-S1112-DLU			
M-S1112-DRU			
M-1118-DLU			
M-1118-DRU	1' - 6"	2'-0 3/4"	
M-S1118-DLU			
M-S1118-DRU			
M-1124-DLU			
M-1124-DRU	2' - 0"	2'-6 3/4"	
M-S1124-DLU			
M-S1124-DRU			
M-1130-DLU			
M-1130-DRU	2' - 6"	3'-0 3/4"	3'-0"
M-S1130-DLU			
M-S1130-DRU			
M-1136-DLU			
M-1136-DRU	3' - 0"	3'-6 3/4"	
M-S1136-DLU			
M-S1136-DRU			
M-1142-DLU			
M-1142-DRU	3' - 6"	4'-0 3/4"	
M-S1142-DLU			
M-S1142-DRU			
M-1148-DLU			
M-1148-DRU	4' - 0"	4'-6 3/4"	
M-S1148-DLU			
M-S1148-DRU			

Drive Mounted Center

Part #	"A"	"B"	"C"
M-1112-DLC			
M-1112-DRC	1' - 0"	1-6 3/4"	
M-S1112-DLC			
M-S1112-DRC			
M-1118-DLC			
M-1118-DRC	1' - 6"	2'-0 3/4"	
M-S1118-DLC			
M-S1118-DRC			
M-1124-DLC			
M-1124-DRC	2' - 0"	2'-6 3/4"	
M-S1124-DLC			
M-S1124-DRC			
M-1130-DLC			
M-1130-DRC	2' - 6"	3'-0 3/4"	3'-0"
M-S1130-DLC			
M-S1130-DRC			
M-1136-DLC			
M-1136-DRC	3' - 0"	3'-6 3/4"	
M-S1136-DLC			
M-S1136-DRC			
M-1142-DLC			
M-1142-DRC	3'-6"	4'-0 3/4"	
M-S1142-DLC			
M-S1142-DRC			
M-1148-DLC			
M-1148-DRC	4' - 0"	4'-6 3/4"	
M-S1148-DLC			
M-S1148-DRC			

MAT TOP IDLER / TAIL SECTION

“M-1100” SERIES

Description

The IDLER END is the portion of conveyor opposing the DRIVE END. The returning chain as it recirculates becomes the product transport chain at this point.

Applications

- Accumulating cases, cartons, Pouches, bags, cans, bottles, etc.
- Minimum back pressure
- Economical

Part #	Idler / End Section		
	"A"	"B"	"C"
M-1112-T	1' - 0"	1-6"	3'-0"
M-S1112-T			
M-1118-T	1' - 6"		
M-S1118-T			
M-1124-T	2' - 0"		
M-S1124-T			
M-1130-T	2' - 6"		
M-S1130-T			
M-1136-T	3' - 0"		
M-S1136-T			
M-1142-T	3' - 6"		
M-S1142-T			
M-1148-T	4' - 0"		
M-S-1148-T			

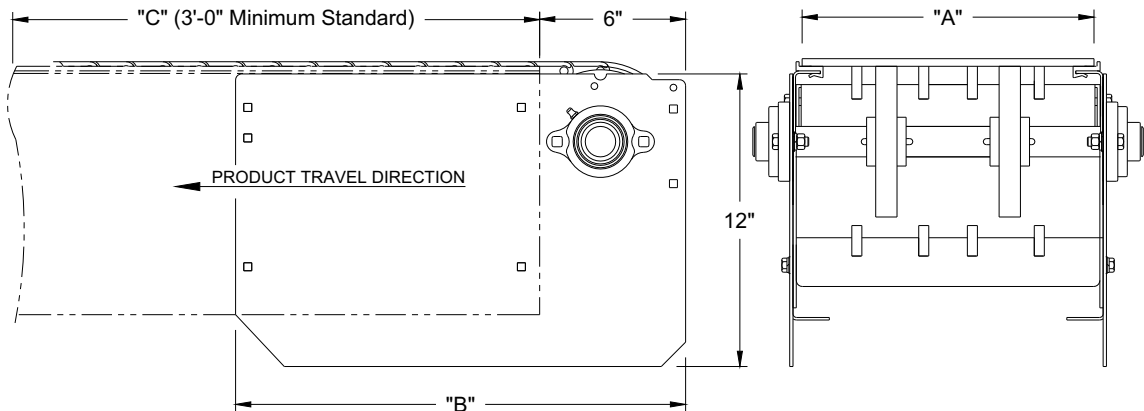

Standard Specifications:

Bed (Painted) - Standard Open design 11 ga. mild steel (Reference picture-this page)

Bed (Stainless Steel) - Standard Open design 12 ga. stainless steel (Reference picture-this page)

Side frame depth - 12" Deep side frame

Mat top chain - Open grid plastic (Polypropylene) low friction 28% open chain (FDA/USDA approved) is included for the Idler /Tail section only

Width - Overall width to be approximately size "B" (Reference picture-this page)

Supports - Floor supports are **not included** with the Idler / Tail section (Reference Conveyor Accessories catalog)

Transfers - End to end transfers are **not included** (Reference Conveyor Accessories catalog)

Guiderails - Guiderails are **not included** (Reference Conveyor Accessories catalog)

Wear strip - Returns and wear strips are included (Reference picture-this page)

Hardware - All connecting plates and fasteners are included for one end. Additional mounting plates are available at an additional cost.

How To Order

Model: **X-X X XX-X-XX**

Component series	Paint color (Leave blank if Stainless Steel)
(M) Mat Top	(01) Blue
(S) Is placed here for Stainless Steel construction	(02) Crème
Mat Top chain series:	(03) Safety Yellow
(9) = Series 900	(04) Safety Orange
(11) = Series 1100	(05) Medium Metallic Grey
(24) = Series 2400	(06) White
Mat Top chain widths:	(07) Dark Blue
(12) = 12" or 1'-0" wide	(T) Is placed here for Tail Section (Idler End)
(18) = 18" or 1'-6" wide	
(24) = 24" or 2'-0" wide	
(30) = 30" or 2'-6" wide	
(36) = 36" or 3'-0" wide	
(42) = 42" or 3'-6" wide	
(48) = 48" or 4'-0" wide	

How To Order

MAT TOP INTERMEDIATE SECTION

"M-2400" SERIES

Description

The intermediate section transports product between the Drive and Idle Assemblies

Applications

- Accumulating light duty cartons, Pouches, bags, cans, bottles, etc.
- Minimum back pressure
- Economical

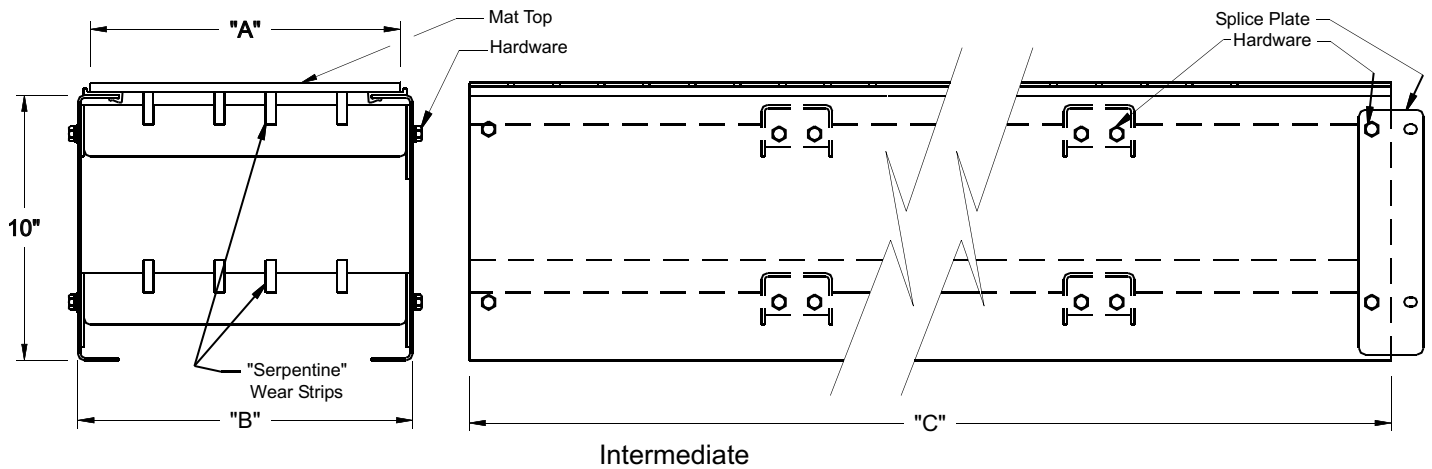

Standard Specifications:

Bed (Painted) - Standard Open design 11 ga. mild steel (Reference picture-this page)

Bed (Stainless Steel) - Standard Open design 12 ga. stainless steel (See picture-this page)

side frame depth: 10 " deep side frame

Mat top chain: Open grid plastic (Polypropylene) low friction 42% open chain (FDA/USDA approved) is included for the intermediate section only.(This chain is capable of side flexing)

Width: Overall width to be approximately size "B" (Reference picture-this page)

Supports: Floor supports are **not included** with the intermediate (Reference Conveyor Accessories catalog)

drive package: standard drive package available (Reference drive section)

Guiderrails: Guiderrails are **not included** (Reference Conveyor Accessories catalog)

Wear strips: Returns and wear strips are included (Reference picture-this page)

Hardware: All connecting plates and fasteners are included for one end. Additional mounting plates are available at an addition cost.

1'-0" Intermediate			
Part #	"A"	"B"	"C"
M-2412-12	1'-0"	1'-0 3/4"	1'-0"
M-S2412-12			
M-2418-12	1'-6"	1'-6 3/4"	
M-S2418-12			
M-2424-12	2'-0"	2'-0 3/4"	
M-S2424-12			
M-2430-12	2'-6"	2'-6 3/4"	
M-S2430-12			
M-2436-12	3'-0"	3'-0 3/4"	
M-S2436-12			
M-2442-12	3'-6"	3'-6 3/4"	
M-S2442-12			
M-2448-12	4'-0"	4'-0 3/4"	
M-S2448-12			

2'-0" Intermediate			
Part #	"A"	"B"	"C"
M-2412-24	1'-0"	1'-0 3/4"	2'-0"
M-S2412-24			
M-2418-24	1'-6"	1'-6 3/4"	
M-S2418-24			
M-2424-24	2'-0"	2'-0 3/4"	
M-S2424-24			
M-2430-24	2'-6"	2'-6 3/4"	
M-S2430-24			
M-2436-24	3'-0"	3'-0 3/4"	
M-S2436-24			
M-2442-24	3'-6"	3'-6 3/4"	
M-S2442-24			
M-2448-24	4'-0"	4'-0 3/4"	
M-S2448-24			

3'-0" Intermediate			
Part #	"A"	"B"	"C"
M-2412-36	1'-0"	1'-0 3/4"	3'-0"
M-S2412-36			
M-2418-36	1'-6"	1'-6 3/4"	
M-S2418-36			
M-2424-36	2'-0"	2'-0 3/4"	
M-S2424-36			
M-2430-36	2'-6"	2'-6 3/4"	
M-S2430-36			
M-2436-36	3'-0"	3'-0 3/4"	
M-S2436-36			
M-2442-36	3'-6"	3'-6 3/4"	
M-S2442-36			
M-2448-36	4'-0"	4'-0 3/4"	
M-S2448-36			

4'-0" Intermediate			
Part #	"A"	"B"	"C"
M-2412-48	1'-0"	1'-0 3/4"	4'-0"
M-S2412-48			
M-2418-48	1'-6"	1'-6 3/4"	
M-S2418-48			
M-2424-48	2'-0"	2'-0 3/4"	
M-S2424-48			
M-2430-48	2'-6"	2'-6 3/4"	
M-S2430-48			
M-2436-48	3'-0"	3'-0 3/4"	
M-S2436-48			
M-2442-48	3'-6"	3'-6 3/4"	
M-S2442-48			
M-2448-48	4'-0"	4'-0 3/4"	
M-S2448-48			

5'-0" Intermediate			
Part #	"A"	"B"	"C"
M-2412-60	1'-0"	1'-0 3/4"	5'-0"
M-S2412-60			
M-2418-60	1'-6"	1'-6 3/4"	
M-S2418-60			
M-2424-60	2'-0"	2'-0 3/4"	
M-S2424-60			
M-2430-60	2'-6"	2'-6 3/4"	
M-S2430-60			
M-2436-60	3'-0"	3'-0 3/4"	
M-S2436-60			
M-2442-60	3'-6"	3'-6 3/4"	
M-S2442-60			
M-2448-60	4'-0"	4'-0 3/4"	
M-S2448-60			

6'-0" Intermediate			
Part #	"A"	"B"	"C"
M-2412-72	1'-0"	1'-0 3/4"	6'-0"
M-S2412-72			
M-2418-72	1'-6"	1'-6 3/4"	
M-S2418-72			
M-2424-72	2'-0"	2'-0 3/4"	
M-S2424-72			
M-2430-72	2'-6"	2'-6 3/4"	
M-S2430-72			
M-2436-72	3'-0"	3'-0 3/4"	
M-S2436-72			
M-2442-72	3'-6"	3'-6 3/4"	
M-S2442-72			
M-2448-72	4'-0"	4'-0 3/4"	
M-S2448-72			

7'-0" Intermediate			
Part #	"A"	"B"	"C"
M-2412-84	1'-0"	1'-0 3/4"	7'-0"
M-S2412-84			
M-2418-84	1'-6"	1'-6 3/4"	
M-S2418-84			
M-2424-84	2'-0"	2'-0 3/4"	
M-S2424-84			
M-2430-84	2'-6"	2'-6 3/4"	
M-S2430-84			
M-2436-84	3'-0"	3'-0 3/4"	
M-S2436-84			
M-2442-84	3'-6"	3'-6 3/4"	
M-S2442-84			
M-2448-84	4'-0"	4'-0 3/4"	
M-S2448-84			

8'-0" Intermediate			
Part #	"A"	"B"	"C"
M-2412-96	1'-0"	1'-0 3/4"	8'-0"
M-S2412-96			
M-2418-96	1'-6"	1'-6 3/4"	
M-S2418-96			
M-2424-96	2'-0"	2'-0 3/4"	
M-S2424-96			
M-2430-96	2'-6"	2'-6 3/4"	
M-S2430-96			
M-2436-96	3'-0"	3'-0 3/4"	
M-S2436-96			
M-2442-96	3'-6"	3'-6 3/4"	
M-S2442-96			
M-2448-96	4'-0"	4'-0 3/4"	
M-S2448-96			

9'-0" Intermediate			
Part #	"A"	"B"	"C"
M-2412-108	1'-0"	1'-0 3/4"	9'-0"
M-S2412-108			
M-2418-108	1'-6"	1'-6 3/4"	
M-S2418-108			
M-2424-108	2'-0"	2'-0 3/4"	
M-S2424-108			
M-2430-108	2'-6"	2'-6 3/4"	
M-S2430-108			
M-2436-108	3'-0"	3'-0 3/4"	
M-S2436-108			
M-2442-108	3'-6"	3'-6 3/4"	
M-S2442-108			
M-2448-108	4'-0"	4'-0 3/4"	
M-S2448-108			

10'-0" Intermediate			
Part #	"A"	"B"	"C"
M-2412-120	1'-0"	1'-0 3/4"	7'-0"
M-S2412-120			
M-2418-120	1'-6"	1'-6 3/4"	
M-S2418-120			
M-2424-120	2'-0"	2'-0 3/4"	
M-S2424-120			
M-2430-120	2'-6"	2'-6 3/4"	
M-S2430-120			
M-2436-120	3'-0"	3'-0 3/4"	
M-S2436-120			
M-2442-120	3'-6"	3'-6 3/4"	
M-S2442-120			
M-2448-120	4'-0"	4'-0 3/4"	
M-S2448-120			

How To Order

Model: **X-X X XX XXX-XX**

Component series (M) Mat Top

(S) Is placed here for Stainless Steel construction

Mat Top chain series:
 (9) = Series 900
 (11) = Series 1100
 (24) = Series 2400

Mat Top chain widths:
 (12) = 12" or 1'-0" wide
 (18) = 18" or 1'-6" wide
 (24) = 24" or 2'-0" wide
 (30) = 30" or 2'-6" wide
 (36) = 36" or 3'-0" wide
 (42) = 42" or 3'-6" wide
 (48) = 48" or 4'-0" wide

Paint color (Leave blank if Stainless Steel)

- (01) Blue
- (02) Crème
- (03) Safety Yellow
- (04) Safety Orange
- (05) Medium Metallic Grey
- (06) White
- (07) Dark Blue

Actual length of intermediate (example: 12 = 1'-0") Refer to selection tables for correct lengths

How To Order

MAT TOP DRIVE SECTION

“M-2400” SERIES

Description

The **DRIVE END** is the portion of conveyor where the motor is located. The product transport chain ends at this location and becomes the return chain as it recirculates.

Applications

- Accumulating cases, cartons, Pouches, bags, cans, bottles, etc.
- Minimum back pressure
- Economical

Drive Mounted High			
Part #	"A"	"B"	"C"
M-2412-DLH	1' - 0"	1'-11 1/8"	3'-0"
M-2412-DRH			
M-S2412-DLH			
M-S2412-DRH			
M-2418-DLH	1' - 6"	2'-5 1/8"	
M-2418-DRH			
M-S2418-DLH			
M-S2418-DRH			
M-2424-DLH	2' - 0"	2'-11 1/8"	
M-2424-DRH			
M-S2424-DLH			
M-S2424-DRH			
M-2430-DLH	2' - 6"	3'-5 1/8"	
M-2430-DRH			
M-S2430-DLH			
M-S2430-DRH			
M-2436-DLH	3' - 0"	3'-11 1/8"	
M-2436-DRH			
M-S2436-DLH			
M-S2436-DRH			
M-2442-DLH	3' - 6"	4'-5 1/8"	
M-2442-DRH			
M-S2442-DLH			
M-S2442-DRH			
M-2448-DLH	4' - 0"	4'-11 1/8"	
M-2448-DRH			
M-S2448-DLH			
M-S2448-DRH			

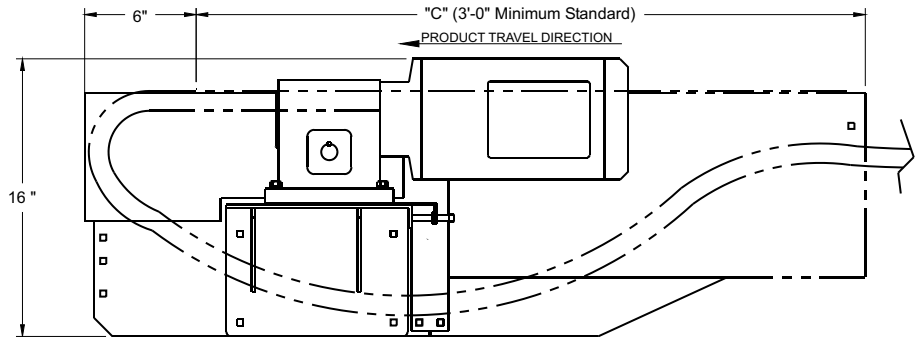
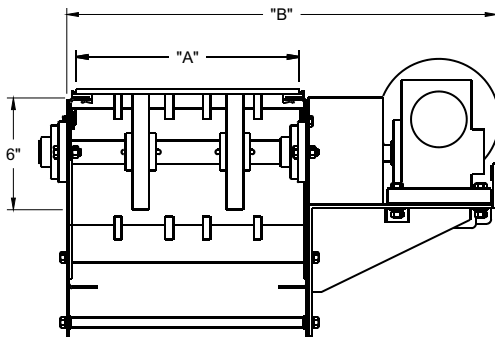

Drive Mounted High (Left Hand Shown)

Standard Specifications:

Bed (Painted) - Standard Open design 11 ga. mild steel (Reference picture-this page)

Bed (Stainless Steel) - Standard Open design 12 ga. stainless steel (Reference picture-this page)

Side frame depth - 15 " Deep side frame (Drive end)

Mat top chain: Open grid plastic (Polypropylene) low friction 42% open chain (FDA/USDA approved) is included for the drive section only.(This chain is capable of side flexing)

Width - Overall width to be approximately size "B" (Reference picture-this page for drive mounted high, Reference pictures next page for drives mounted low and center)

Supports - Floor supports are **not provided** with the drive section (Reference Conveyor Accessories catalog)

Transfers - End to end transfers are **not included** (Reference Conveyor Accessories catalog)

Drive package - UP to 1 hp 208-230-4603/60 motor std. Larger horsepower motor are available. Fixed speed between 50 and 200 F.P.M. (Specify) (Reference speed selection section)

Guiderails - Guiderails are **not included** (Reference Conveyor Accessories catalog)

Wear strip - Returns and wear strips are included (Reference picture-this page)

Hardware - All connecting plates and fasteners are included for one end. Additional mounting plates are available at an additional cost.

Electrical - Electrical connections are **not included** (Reference Controls Accessories catalog)

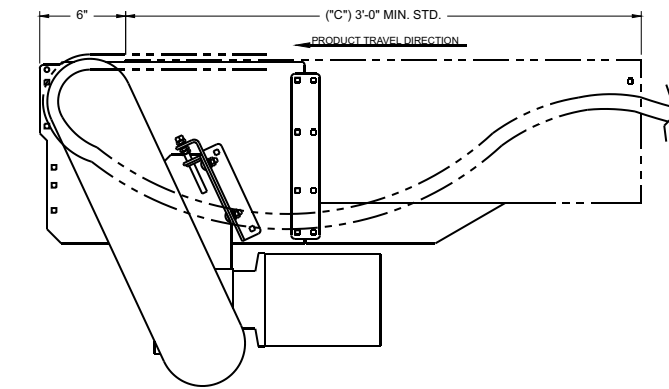
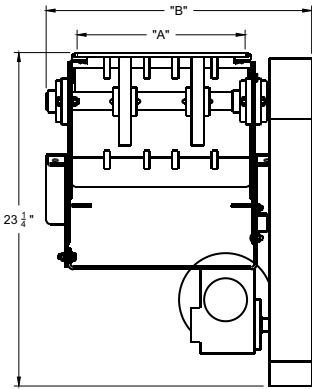

Drive mounted Low (Left Hand Shown)

Drive Mounted Low			
Part #	"A"	"B"	"C"
M-2412-DLU			
M-2412-DRU			
M-S2412-DLU	1' - 0"	1-6 3/4"	
M-S2412-DRU			
M-2418-DLU			
M-2418-DRU	1' - 6"	2'-0 3/4"	
M-S2418-DLU			
M-S2418-DRU			
M-2424-DLU			
M-2424-DRU	2' - 0"	2'-6 3/4"	
M-S2424-DLU			
M-S2424-DRU			
M-2430-DLU			
M-2430-DRU	2' - 6"	3'-0 3/4"	3'-0"
M-S2430-DLU			
M-S2430-DRU			
M-2436-DLU			
M-2436-DRU	3' - 0"	3'-6 3/4"	
M-S2436-DLU			
M-S2436-DRU			
M-2442-DLU			
M-2442-DRU	3' - 6"	4'-0 3/4"	
M-S2442-DLU			
M-S2442-DRU			
M-2448-DLU			
M-2448-DRU	4' - 0"	4'-6 3/4"	
M-S2448-DLU			
M-S2448-DRU			

How To Order

Model: X-X XX-XX-XXX-XX-XX-XXX

- Component series (M) Mat Top
- (S) Is placed here for Stainless Steel construction
- Mat Top chain series:
 - (9) = Series 900
 - (11) = Series 1100
 - (24) = Series 2400
- Mat Top chain widths:
 - (12) = 12" or 1'-0" wide
 - (18) = 18" or 1'-6" wide
 - (24) = 24" or 2'-0" wide
 - (30) = 30" or 2'-6" wide
 - (36) = 36" or 3'-0" wide
 - (42) = 42" or 3'-6" wide
 - (48) = 48" or 4'-0" wide
- Denotes F.P.M. (Feet Per Minute) requirements. Refer to selection tables for correct F.P.M. (example: 150 = 150 F.P.M.)
- Denotes horse power requirements:
 - (05) 1/2 HP (Included In Standard pricing)
 - (75) 3/4 HP (Add to std. price)
 - (10) 1 HP (Add to std. price)
 - (15) 1 1/2 HP (Add to std. price)
- Paint color (Leave blank if Stainless Steel)
 - (01) Blue
 - (02) Crème
 - (03) Safety Yellow
 - (04) Safety Orange
 - (05) Medium Metallic Grey
 - (06) White
 - (07) Dark Blue
- Mat Top drive position:
 - (DLH) Drive, Left Hand, Mounted High
 - (DRH) Drive, Right Hand, Mounted High
 - (DLU) Drive, Left Hand, Mounted Low
 - (DRU) Drive, Right Hand, Mounted Low
 - (DLC) Drive, Left Hand, Mounted Low
 - (DRC) Drive, Right Hand, Mounted Low

How To Order

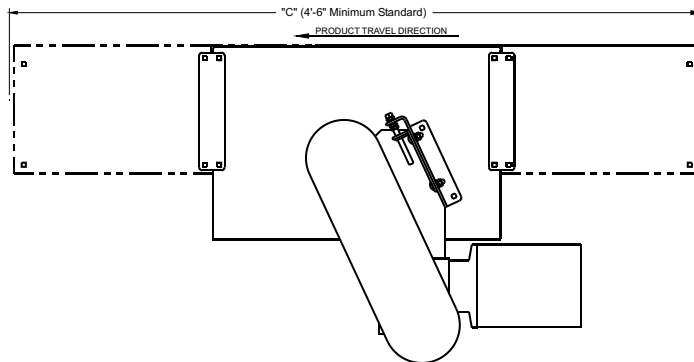
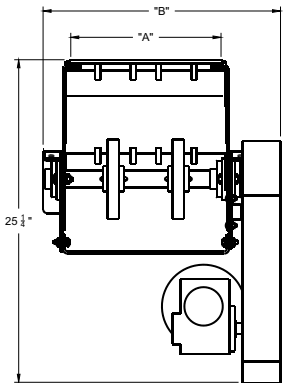

Drive Mounted Low Center (Left Hand Shown)

Drive Mounted Center			
Part #	"A"	"B"	"C"
M-2412-DLC			
M-2412-DRC			
M-S2412-DLC	1' - 0"	1-6 3/4"	
M-S2412-DRC			
M-2418-DLC			
M-2418-DRC	1' - 6"	2'-0 3/4"	
M-S2418-DLC			
M-S2418-DRC			
M-2424-DLC			
M-2424-DRC	2' - 0"	2'-6 3/4"	
M-S2424-DLC			
M-S2424-DRC			
M-2430-DLC			
M-2430-DRC	2' - 6"	3'-0 3/4"	3'-0"
M-S2430-DLC			
M-S2430-DRC			
M-2436-DLC			
M-2436-DRC	3' - 0"	3'-6 3/4"	
M-S2436-DLC			
M-S2436-DRC			
M-2442-DLC			
M-2442-DRC	3'-6 "	4'-0 3/4"	
M-S2442-DLC			
M-S2442-DRC			
M-2448-DLC			
M-2448-DRC	4' - 0"	4'-6 3/4"	
M-S2448-DLC			
M-S2448-DRC			

MAT TOP IDLER / TAIL SECTION

“M-2400” SERIES

Description

The IDLER END is the portion of conveyor opposing the DRIVE END. The returning chain as it recirculates becomes the product transport chain at this point.

Applications

- Accumulating cases, cartons, Pouches, bags, cans, bottles, etc.
- Minimum back pressure
- Economical

Idler / End Section			
Part #	"A"	"B"	"C"
M-2412-T	1' - 0"	1-6"	3'-0"
M-S2412-T			
M-2418-T	1' - 6"		
M-S2418-T			
M-2424-T	2' - 0"		
M-S1124-T			
M-2430-T	2' - 6"		
M-S2430-T			
M-2436-T	3' - 0"		
M-S2436-T			
M-2442-T	3' - 6"		
M-S2442-T			
M-2448-T	4' - 0"		
M-S-2448-T			

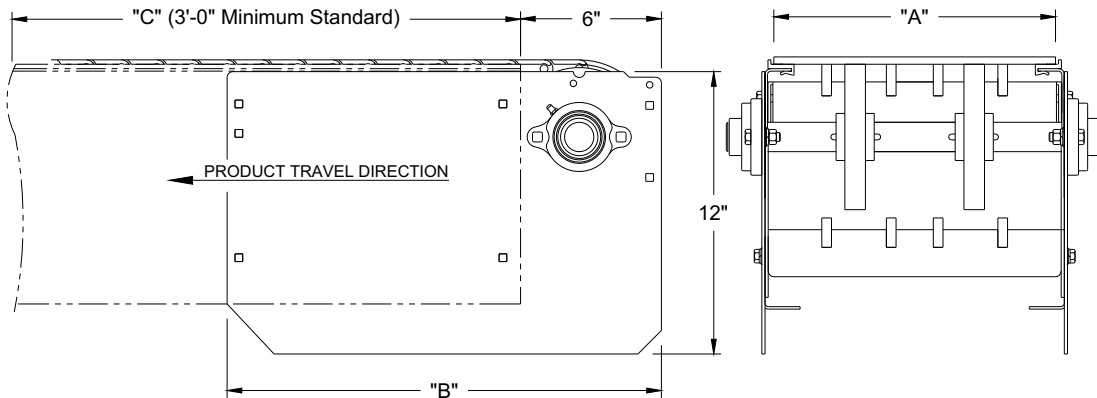

Standard Specifications:

Bed (Painted) - Standard Open design 11 ga. mild steel (Reference picture-this page)

Bed (Stainless Steel) - Standard Open design 12 ga. stainless steel (Reference picture-this page)

Side frame depth -12" Deep side frame

Mat top chain: Open grid plastic (Polypropylene) low friction 42% open chain (FDA/USDA approved) is included for the Idler / Tail section only.(This chain is capable of side flexing)

Width - Overall width to be approximately size "B" (Reference picture-this page)

Supports - Floor supports are **not included** with the idler / Tail section (Reference Conveyor Accessories catalog)

Transfers - End to end transfers are **not included** (Reference Conveyor Accessories catalog)

Guiderails - Guiderails are **not included** (Reference Conveyor Accessories catalog)

Wear strip - Returns and wear strips are included (Reference picture-this page)

Hardware - All connecting plates and fasteners are included for one end. Additional mounting plates are available at an additional cost.

How To Order

Model: **X-X X XX-X-XX**

Component series (M) Mat Top		Paint color (Leave blank if Stainless Steel)
(S) Is placed here for Stainless Steel construction		(01) Blue
Mat Top chain series: (9) = Series 900 (11) = Series 1100 (24) = Series 2400		(02) Crème (03) Safety Yellow (04) Safety Orange (05) Medium Metallic Grey (06) White (07) Dark Blue
Mat Top chain widths: (12) = 12" or 1'-0" wide (18) = 18" or 1'-6" wide (24) = 24" or 2'-0" wide (30) = 30" or 2'-6" wide (36) = 36" or 3'-0" wide (42) = 42" or 3'-6" wide (48) = 48" or 4'-0" wide		(T) Is placed here for Tail Section (Idler End)

How To Order

F.P.M. SELECTION					
Part #	Reducer Ratio	Drive Sprocket	Driven Sprocket	Sprocket Ratio	Max Input HP
50 FPM	30:1	14	23	1.64	.75
55 FPM	30:1	14	22	1.57	.75
60 FPM	30:1	15	22	1.47	.75
65 FPM	25:1	14	22	1.57	.79
70 FPM	25:1	15	22	1.47	.79
75 FPM	25:1	14	19	1.36	.79
80 FPM	20:1	14	23	1.64	1.00
85 FPM	20:1	15	22	1.47	1.00
90 FPM	20:1	15	22	1.47	1.00
95 FPM	20:1	16	22	1.38	1.00
100 FPM	20:1	15	20	1.33	1.00
105 FPM	20:1	16	20	1.25	1.00
110 FPM	15:1	14	22	1.57	1.20
115 FPM	15:1	15	23	1.53	1.20
120 FPM	15:1	15	22	1.47	1.20
125 FPM	15:1	15	21	1.40	1.20
130 FPM	15:1	14	19	1.36	1.20
135 FPM	15:1	16	21	1.31	1.20
140 FPM	15:1	15	19	1.27	1.20
145 FPM	15:1	15	18	1.2	1.20
150 FPM	15:1	17	20	1.18	1.20
155 FPM	15:1	15	17	1.13	1.20
160 FPM	15:1	20	22	1.10	1.20
165 FPM	15:1	15	16	1.07	1.20
170 FPM	10:1	14	22	1.57	1.70
175 FPM	10:1	14	21	1.50	1.70
180 FPM	10:1	13	19	1.46	1.70
185 FPM	10:1	14	20	1.43	1.70
190 FPM	10:1	15	21	1.40	1.70
195 FPM	10:1	14	19	1.36	1.70
200 FPM	10:1	16	21	1.31	1.70

THREE-PHASE MOTOR STANDARDS			
1/2 HP	208V	2.4	250V - 3 AMP 250V - 3 AMP 600V - 1 1/2 AMP
	230V	2.4	
	460V	1.2	
3/4 HP	208V	2.8	250V - 3 1/2 AMP 250V - 4 AMP 600V - 2 AMP
	230V	3.0	
	460V	1.5	
1 HP	208V	3.8	250V - 5 AMP 250V - 4 1/2 AMP 600V - 2 1/4 AMP
	230V	3.4	
	460V	1.7	
1 1/2 HP	208V	5.6	250V - 7 AMP 250V - 7 AMP 600V - 3 1/2 AMP
	230V	5.6	
	460V	2.8	

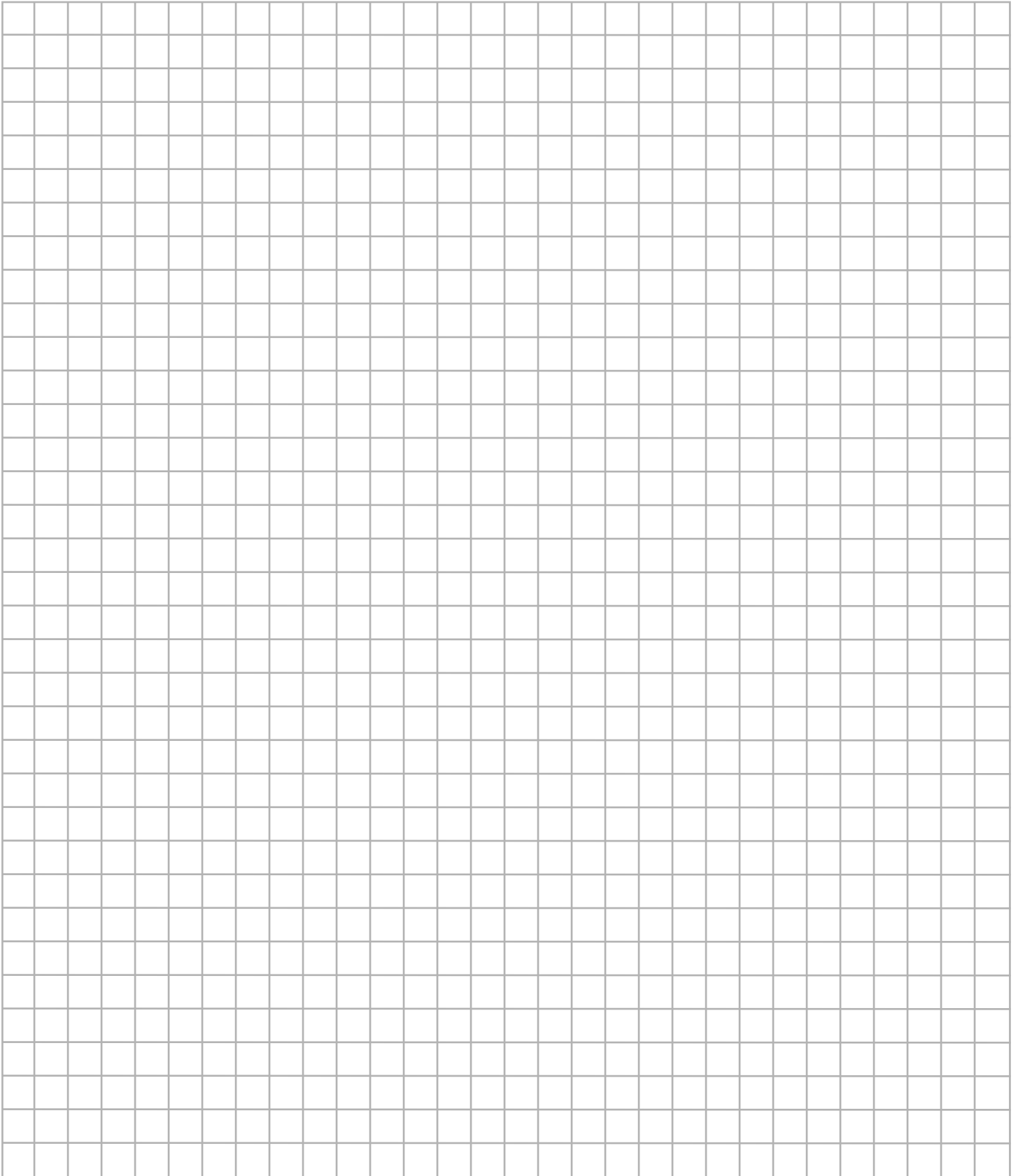

Notes

A large rectangular area with rounded corners, containing 30 horizontal dotted lines for writing notes.

Notes

A large rectangular area with rounded corners, containing 30 horizontal dotted lines for writing notes.



— *Dillin Automation Systems Corp.* —
Creating Optimal Solutions

8030 Broadstone Road
Perrysburg, Ohio 43551

P. 419-666-6789
F. 419-666-4020
www.dillinautomation.com